



ASSEMBLY INSTRUCTIONS FOR 2B2706 INTERNATIONAL STADIUM MATCH GOAL

THIS UNIT MUST BE ASSEMBLED AND INSTALLED BY A MINIMUM OF TWO QUALIFIED PERSONS

1. Unpack all parts and check for damage that may have occurred during shipping. If damage has occurred, notify Kwik Goal immediately. Lay out all parts. Remove all cardboard and packaging immediately. Wet or damp packaging may damage contents.
2. Read through all instructions before beginning assembly and installation.

NOTE: Components may be packaged in one or more additional boxes.

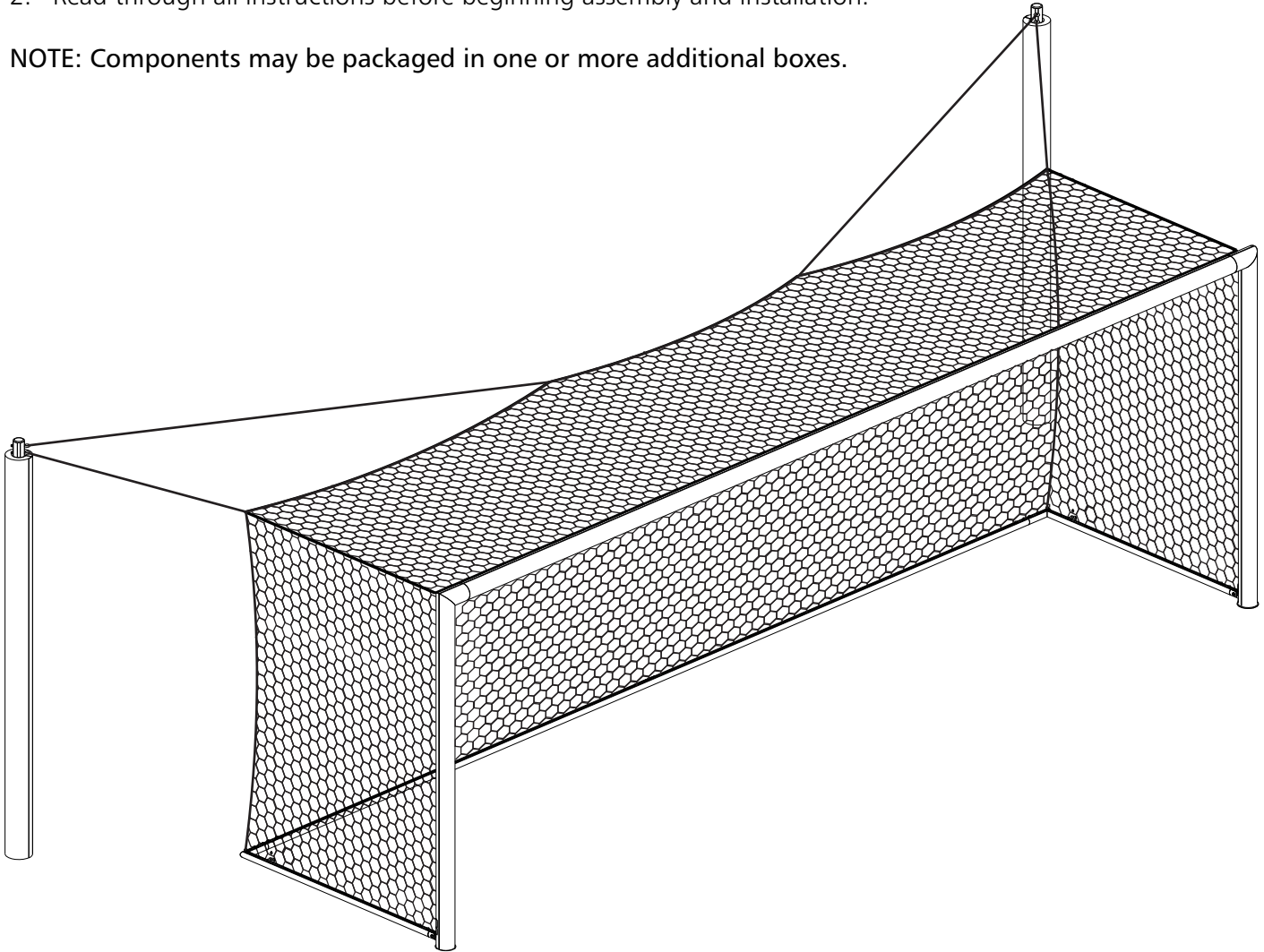

CAUTION

This goal has been designed to be used for the game of soccer only. Goal posts must be anchored AT ALL TIMES and shall be secured against overturning. Do not climb on the net or goal framework at any time! All fastenings must be checked to insure they are fully tightened before and after each use of this product. Goal posts not in use must be disassembled and properly stored in a safe, secure area (See included Guidelines for Movable Soccer Goal Safety.). Assembled goal posts should not be left unattended. Remove nets when goals are not in use. Do not use this equipment during the threat of high winds. Goal posts should be checked for safety before and after each use.

All warning and safety labels included with this product must be visible at all times.

Any modifications to this or any Kwik Goal product will void any and all warranties.

140 Pacific Drive Quakertown, PA 18951

800-531-4252 Kwikgoal.com

© 2025 Kwik Goal Ltd.

NZ487 Rev. 04/11/25



⚠️ WARNING

IMPORTANT GOAL SAFETY INSTRUCTIONS
READ CAREFULLY

- Check for structural integrity and proper connecting hardware before every use. Replace damaged or missing parts or fasteners immediately.
- Safety/Warning labels must be clearly visible.
- Securely anchor movable soccer goals at ALL times.
- Always instruct players, managers, coaches, trainers, teachers, maintenance workers and all other personnel who might come in contact with the goal, on the safe handling of and potential dangers associated with movable soccer goals.
- Always exercise extreme caution when moving goals and provide adequate manpower to move goals of varied sizes and weights. Movable soccer goals should only be moved by authorized personnel.
- NEVER allow anyone to climb on the net or goal framework.
- Movable soccer goals should only be used on LEVEL fields, NEVER on a slope or hill area.
- Remove nets when goals are not in use.
- Most of the tip-over injuries occurred when goals were unattended. Anchor or chain one goal to another or to nearby fence posts, dugouts, or any other similar sturdy fixture when not in use. If this is not practical, store movable soccer goals in a place where children cannot have access to them.
- Fully disassemble goals for seasonal storage.

Parts

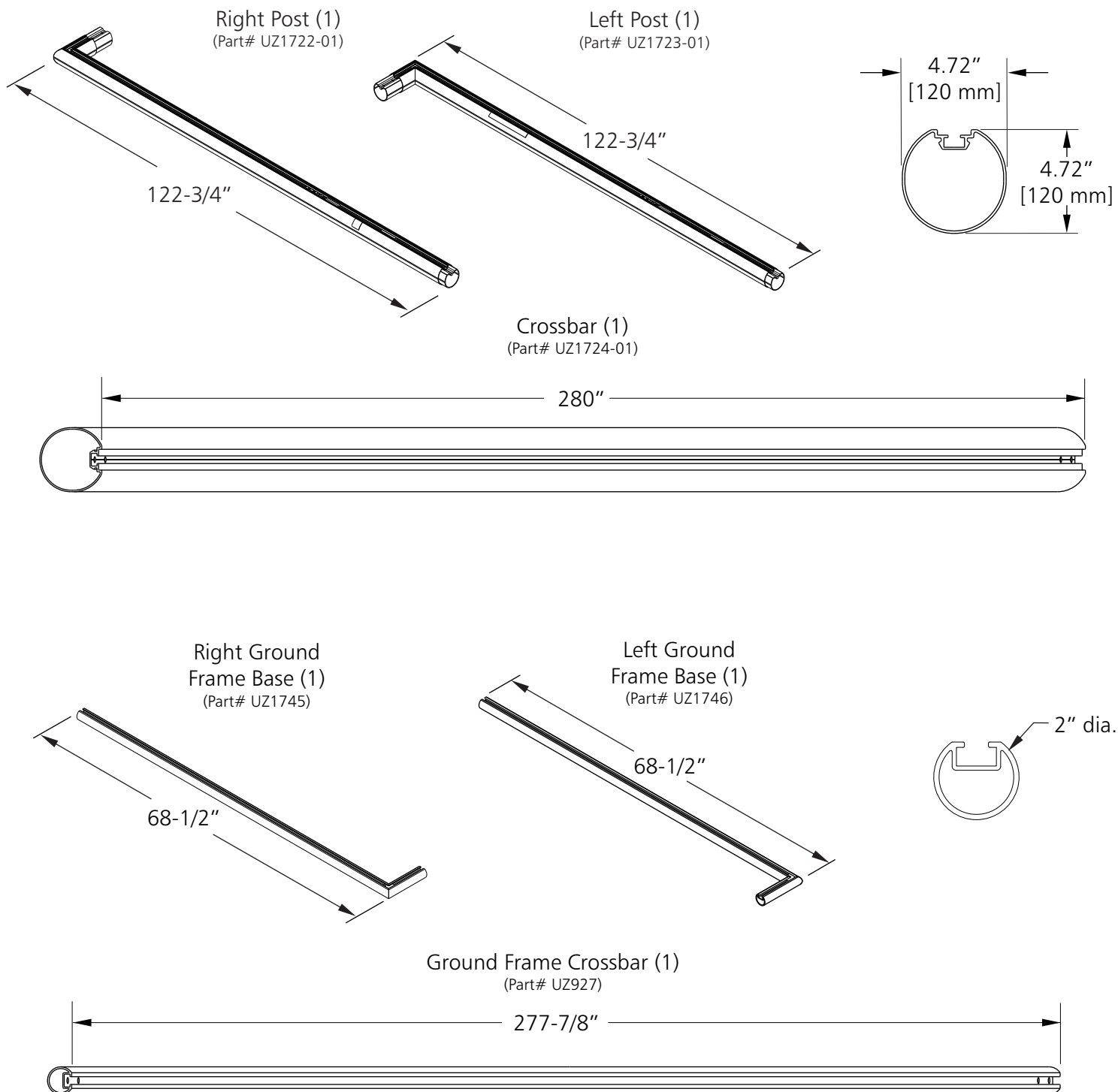

CAUTION

This goal has been designed to be used for the game of soccer only. Goal posts must be anchored AT ALL TIMES and shall be secured against overturning. Do not climb on the net or goal framework at any time! All fastenings must be checked to insure they are fully tightened before and after each use of this product. Goal posts not in use must be disassembled and properly stored in a safe, secure area (See included Guidelines for Movable Soccer Goal Safety.). Assembled goal posts should not be left unattended. Remove nets when goals are not in use. Do not use this equipment during the threat of high winds. Goal posts should be checked for safety before and after each use. All warning and safety labels included with this product must be visible at all times. Any modifications to this or any Kwik Goal product will void any and all warranties.

Parts continued:

Left Adjustable
Ground Sleeve Box (1)
(Part# UZ1721-02)

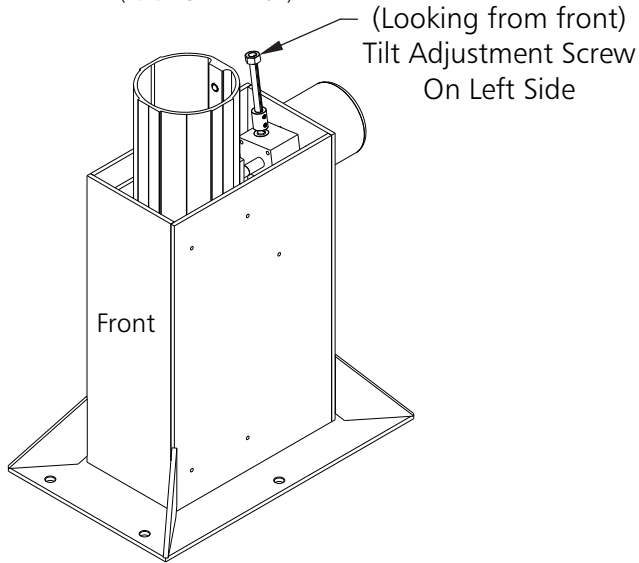

Right Adjustable
Ground Sleeve Box (1)
(Part# UZ1721-01)

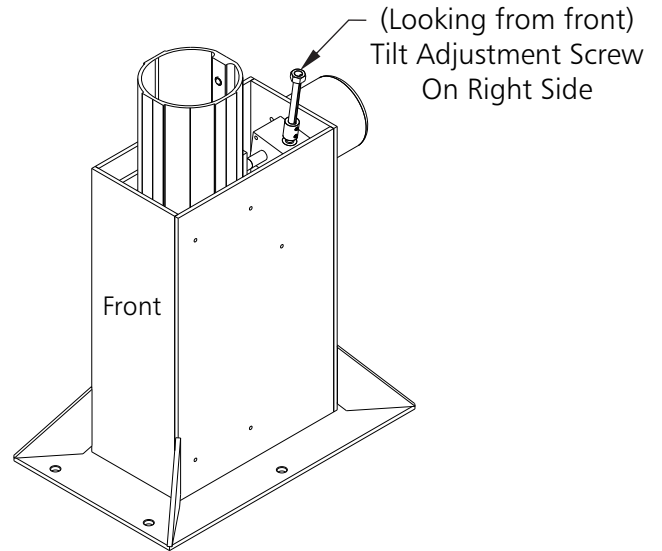

Left Ground
Sleeve Box Cap (1)
(Part# VZ932-02)

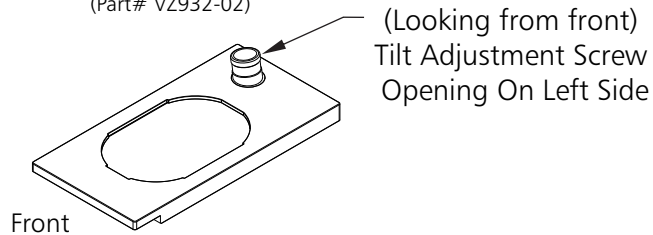

Right Ground
Sleeve Box Cap (1)
(Part# VZ932-01)

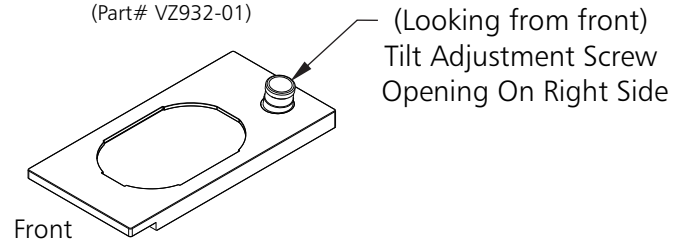

Ground Sleeve
Box Cap Bottom (2)
(Part# VZ938)

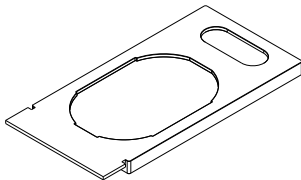

Ground Sleeve
Box Slide Cap (2)
(Part# VZ937)

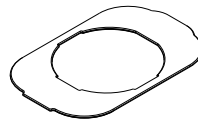

Post Ground Sleeve Cap (2)
(Part# VZ946)

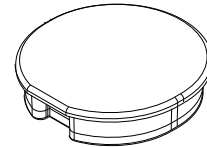

Rubber Tube Cap (2)
(Part# VZ968-01)

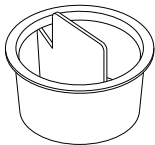

Rubber Tube (2)
(Part# VZ963-02)

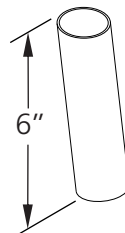

Plastic Barrier (2)
(Part# VZ964-02)

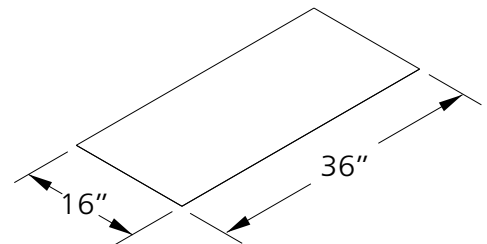

CAUTION

This goal has been designed to be used for the game of soccer only. Goal posts must be anchored AT ALL TIMES and shall be secured against overturning. Do not climb on the net or goal framework at any time! All fastenings must be checked to insure they are fully tightened before and after each use of this product. Goal posts not in use must be disassembled and properly stored in a safe, secure area (See included Guidelines for Movable Soccer Goal Safety.). Assembled goal posts should not be left unattended. Remove nets when goals are not in use. Do not use this equipment during the threat of high winds. Goal posts should be checked for safety before and after each use. All warning and safety labels included with this product must be visible at all times. Any modifications to this or any Kwik Goal product will void any and all warranties.

Parts continued:

Back Pole (2)
(Part# UZ1749-01)

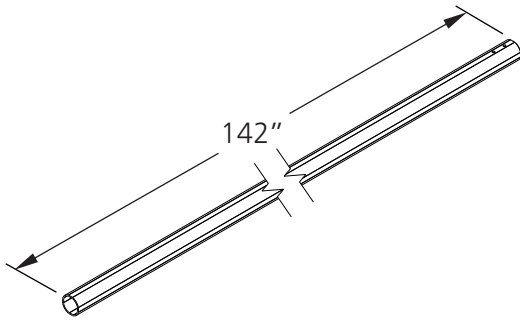

Left Back Pole Pad (1)
(Part# VZ942-01)

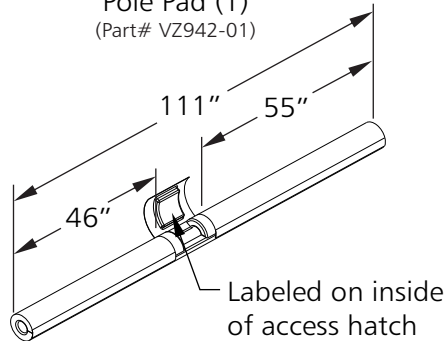

Right Back Pole Pad (1)
(Part# VZ942-02)

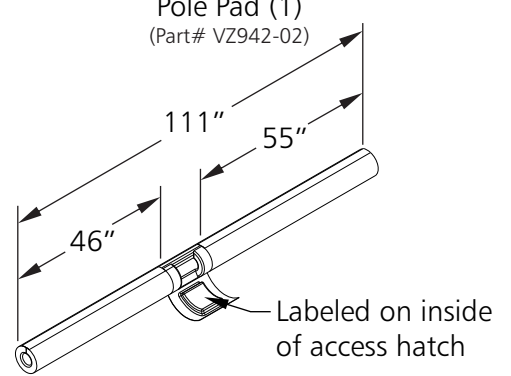

Ground Frame Hinge (2)
(Part# PT657 pack of 2)

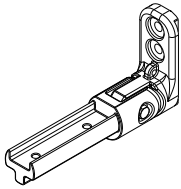

Ground Frame Connector Plate (2)
(Part# UZ928)

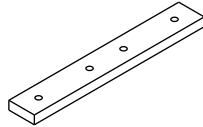

Channel Spacer (8)
(Part# UZ812)

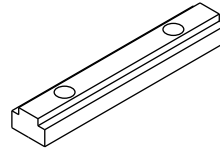

Net Clip (80)
(Part# JZ307-01 Pack of 80)

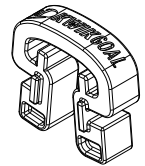

Ground Frame Anchor (2)
(Part# UZ1747)

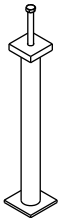

Ground Frame Anchor Cap (2)
(Part# VZ972-01)

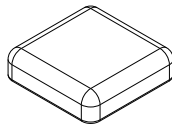

Knob (2)
(Part# VZ687)

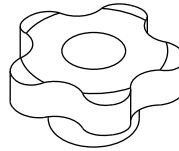

Ground Frame Slot Cover (2)
(Part# UZ1744-01)

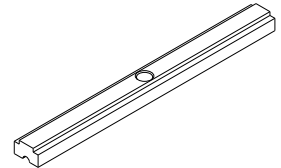

Ground Frame Anchor Spacer (2)
(Part# UZ1748)

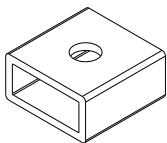

Back Pole Ground Sleeve (2)
(Part# UZ1750-01)

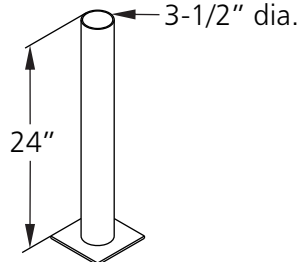

Back Pole Ground Sleeve Cap (2)
(Part# VZ947-01)

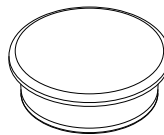

Net Tension Winch (4)
(Part# VZ232)
(Replacement pack # VZ958)

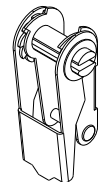

CAUTION

This goal has been designed to be used for the game of soccer only. Goal posts must be anchored AT ALL TIMES and shall be secured against overturning. Do not climb on the net or goal framework at any time! All fastenings must be checked to insure they are fully tightened before and after each use of this product. Goal posts not in use must be disassembled and properly stored in a safe, secure area (See included Guidelines for Movable Soccer Goal Safety.). Assembled goal posts should not be left unattended. Remove nets when goals are not in use. Do not use this equipment during the threat of high winds. Goal posts should be checked for safety before and after each use.

All warning and safety labels included with this product must be visible at all times.

Any modifications to this or any Kwik Goal product will void any and all warranties.

Parts continued:

Net Fastener (1)
(Part# MNF-1
Roll of 12ft)



Net (1)
(Part# 3B7802)



Back Corner Net Rope (2)
(Part# VZ783-06)
(Replacement pack # JZ301-02)

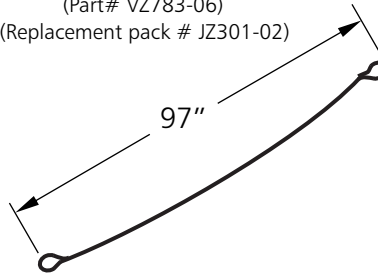

Net Rope (2)
(Part# VZ783-05)
(Replacement pack # JZ301-02)

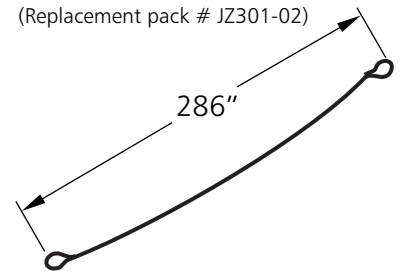

Hardware

Note: Hardware may be packaged separately in one or more boxes. Open all packages before beginning assembly.

3/8" x 4" Hex Bolt (Part# TZ434)	(2)
3/8" x 1-1/4" Hex Bolt (Part# TZ59)	(16)
3/8" Lock Washer (Part# TZ65)	(16)
3/8" Flat Washer (Part# TZ60)	(22)
3/8" Set Screw (Part# TZ455-001)	(2)
1/4" X 1" Hex Bolt (Part# TZ373)	(4)
1/4" Flat Washer (Part# TZ361)	(4)
1/4" x 1" Flat Washer (Part# TZ450-001)	(4)
1/4" Lock Washer (Part# TZ187)	(4)
1/4" Tie Down Ring (Part# TZ443)	(4)
Ground Frame Hinge Pack (Part# PT657)	(1)
3/8" x 1" Hex Bolt (Part# TZ1)	(4)
3/8" Square Nut (Part# TZ247)	(4)
3/8" Lock Washer (Part# TZ65)	(4)
3/8" Flat Washer (Part# TZ60)	(4)
Tension Strap Kit (Part# VZ958)	(2)
Nylon Strap (VZ233)	(2)
Net Tension Winch (** See Parts List)	(2)
Snap Link (Part# VZ189)	(2)
3/8" x 3-1/4" Eye Bolt (TZ198)	(2)
3/8" Lock Nut (Part# TZ197)	(2)
3/8" Flat Washer (Part# TZ189)	(2)
5/16" Lock Nut Thin (Part# TZ321)	(2)
5/16" Flat Washer (Part# TZ4)	(4)
5/16" x 3-1/2" Hex Bolt (Part# TZ240)	(2)

Adjustment Tools (Included)

Socket Driver with
8mm & 11/16" Sockets

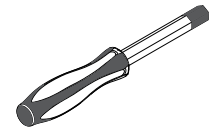

Assembly Tools Required

7/16", 1/2",
& 9/16"
Wrenches

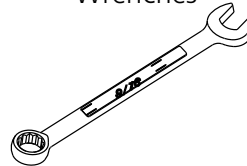

Scissors

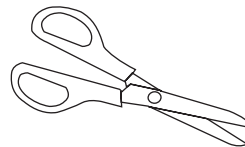

Level

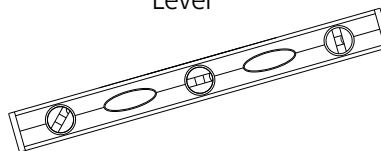

Ratchet with
7/16", 1/2"
& 9/16"
Sockets

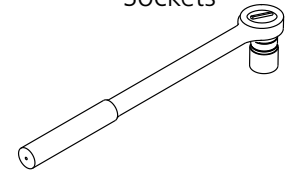

Mallet

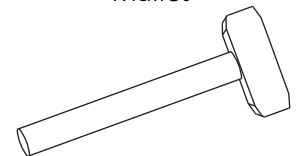

Utility Knife

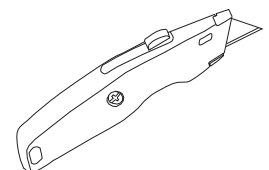

Materials Required (PER GOAL)

- 1.10 cubic yard [0.84 cubic meter] - Concrete
- 0.75 cubic yard [0.57 cubic meter] - Clean stone (1/4" - 3/4") [0.6cm - 2cm]
- Tape/Plastic Wrap (To cover exposed parts before pouring concrete)
- 12-16 Gallon Heavy Duty Trash Bags (2)

*****CAUTION*****

This goal has been designed to be used for the game of soccer only. Goal posts must be anchored AT ALL TIMES and shall be secured against overturning. Do not climb on the net or goal framework at any time! All fastenings must be checked to insure they are fully tightened before and after each use of this product. Goal posts not in use must be disassembled and properly stored in a safe, secure area (See included Guidelines for Movable Soccer Goal Safety.). Assembled goal posts should not be left unattended. Remove nets when goals are not in use. Do not use this equipment during the threat of high winds. Goal posts should be checked for safety before and after each use.

All warning and safety labels included with this product must be visible at all times.

Any modifications to this or any Kwik Goal product will void any and all warranties.

3. Attach the tie down rings to the left and right posts as shown below, and then connect the posts to the crossbar. Note direction of decals on crossbar before fastening; the decals MUST be oriented as shown below. Be sure connections are pressed firmly together before tightening hex bolts.

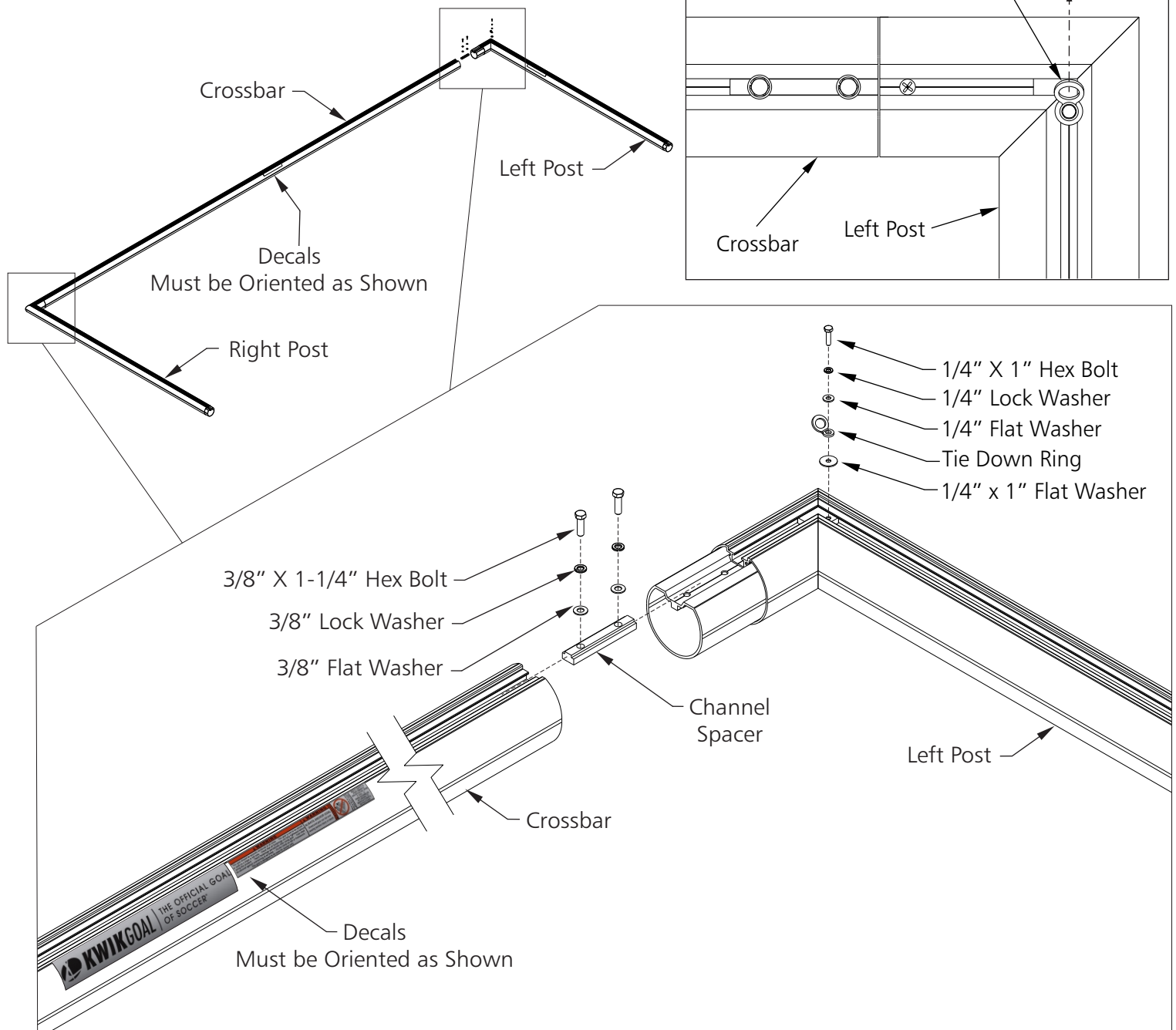

*****CAUTION*****

This goal has been designed to be used for the game of soccer only. Goal posts must be anchored AT ALL TIMES and shall be secured against overturning. Do not climb on the net or goal framework at any time! All fastenings must be checked to insure they are fully tightened before and after each use of this product. Goal posts not in use must be disassembled and properly stored in a safe, secure area (See included Guidelines for Movable Soccer Goal Safety.). Assembled goal posts should not be left unattended. Remove nets when goals are not in use. Do not use this equipment during the threat of high winds. Goal posts should be checked for safety before and after each use. All warning and safety labels included with this product must be visible at all times. Any modifications to this or any Kwik Goal product will void any and all warranties.

4. Attach the left and right ground frame bases to the ground frame crossbar as shown. Note direction of decal on the ground frame crossbar before fastening; the decals MUST be oriented as shown below. Be sure connections are pressed firmly together before tightening hex bolts.

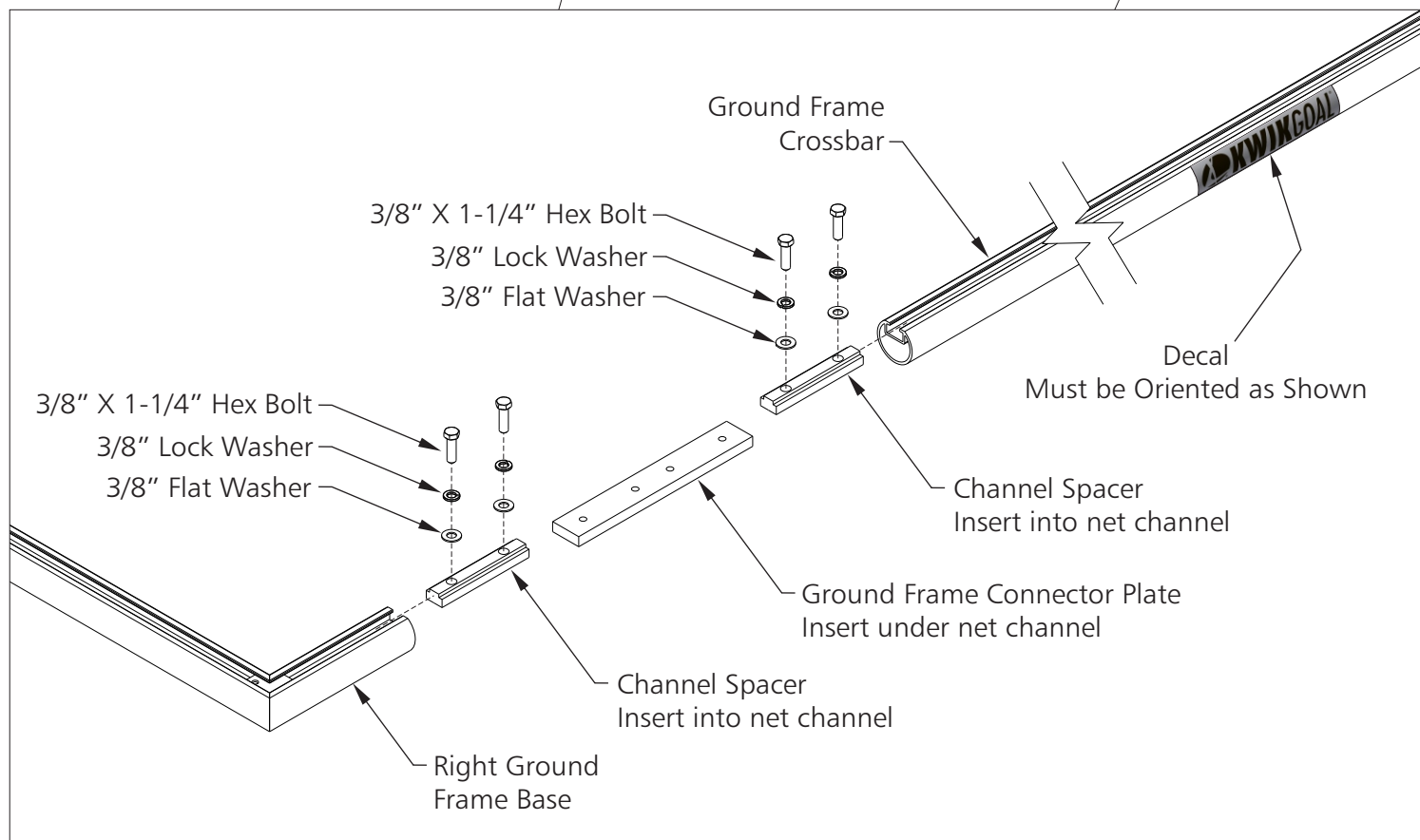
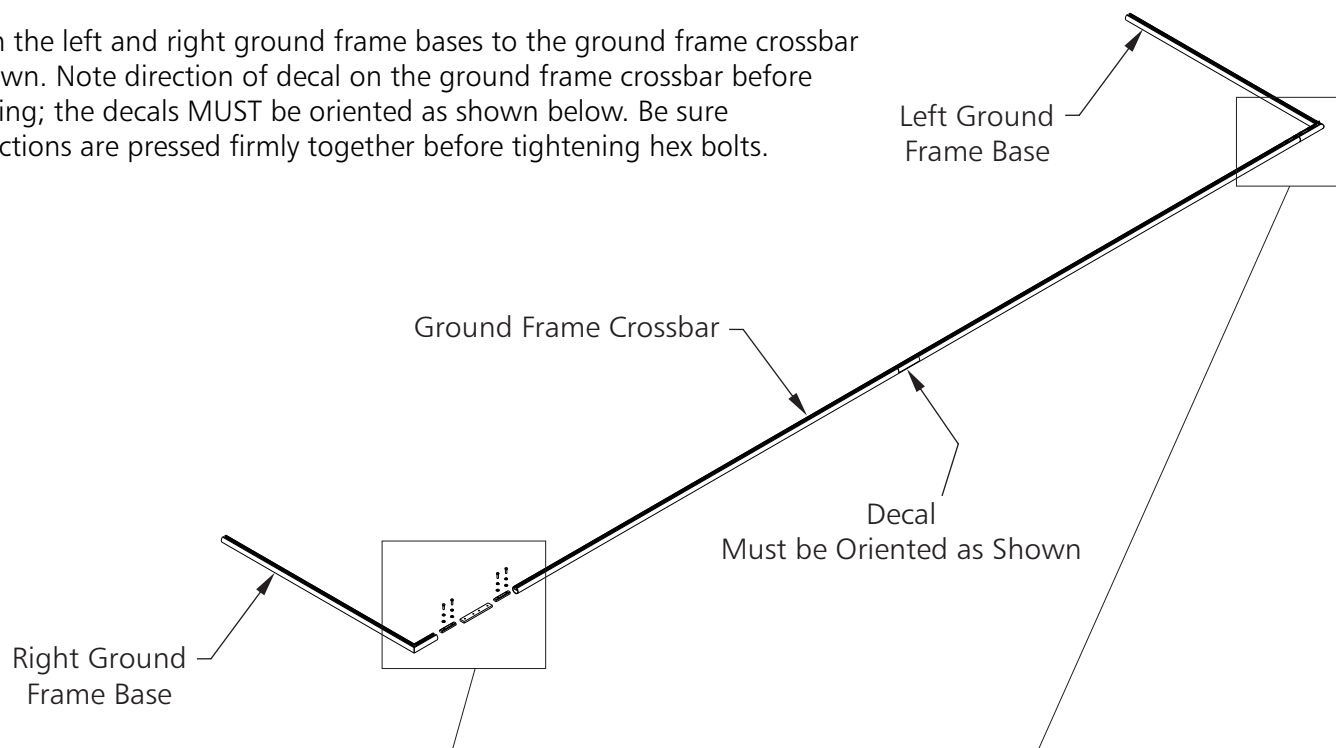

*****CAUTION*****

This goal has been designed to be used for the game of soccer only. Goal posts must be anchored AT ALL TIMES and shall be secured against overturning. Do not climb on the net or goal framework at any time! All fastenings must be checked to insure they are fully tightened before and after each use of this product. Goal posts not in use must be disassembled and properly stored in a safe, secure area (See included Guidelines for Movable Soccer Goal Safety.). Assembled goal posts should not be left unattended. Remove nets when goals are not in use. Do not use this equipment during the threat of high winds. Goal posts should be checked for safety before and after each use.

All warning and safety labels included with this product must be visible at all times.
Any modifications to this or any Kwik Goal product will void any and all warranties.

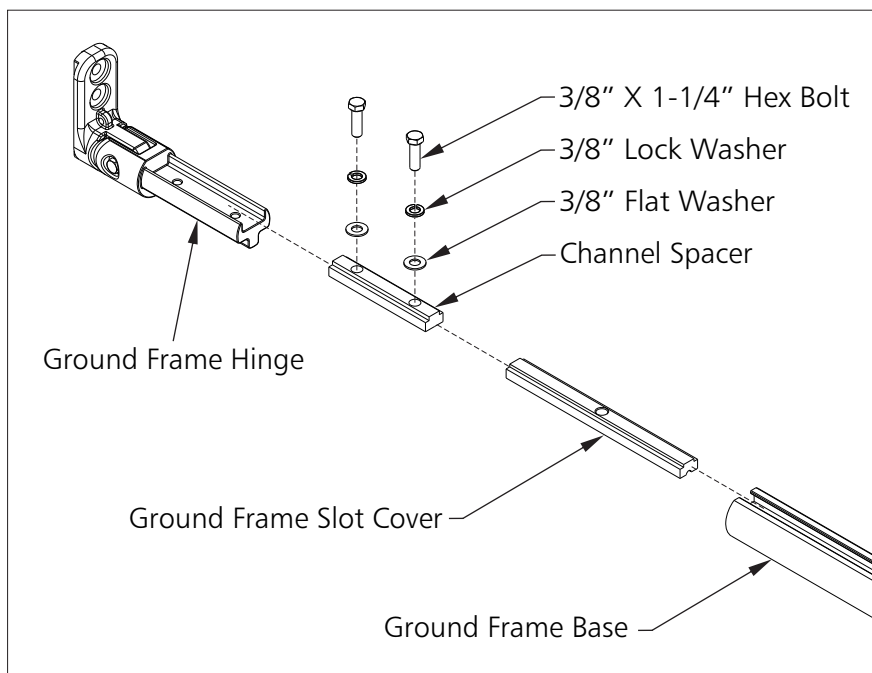

5. Insert a ground frame slot cover and attach a ground frame hinge onto both the left and right ground frame bases.

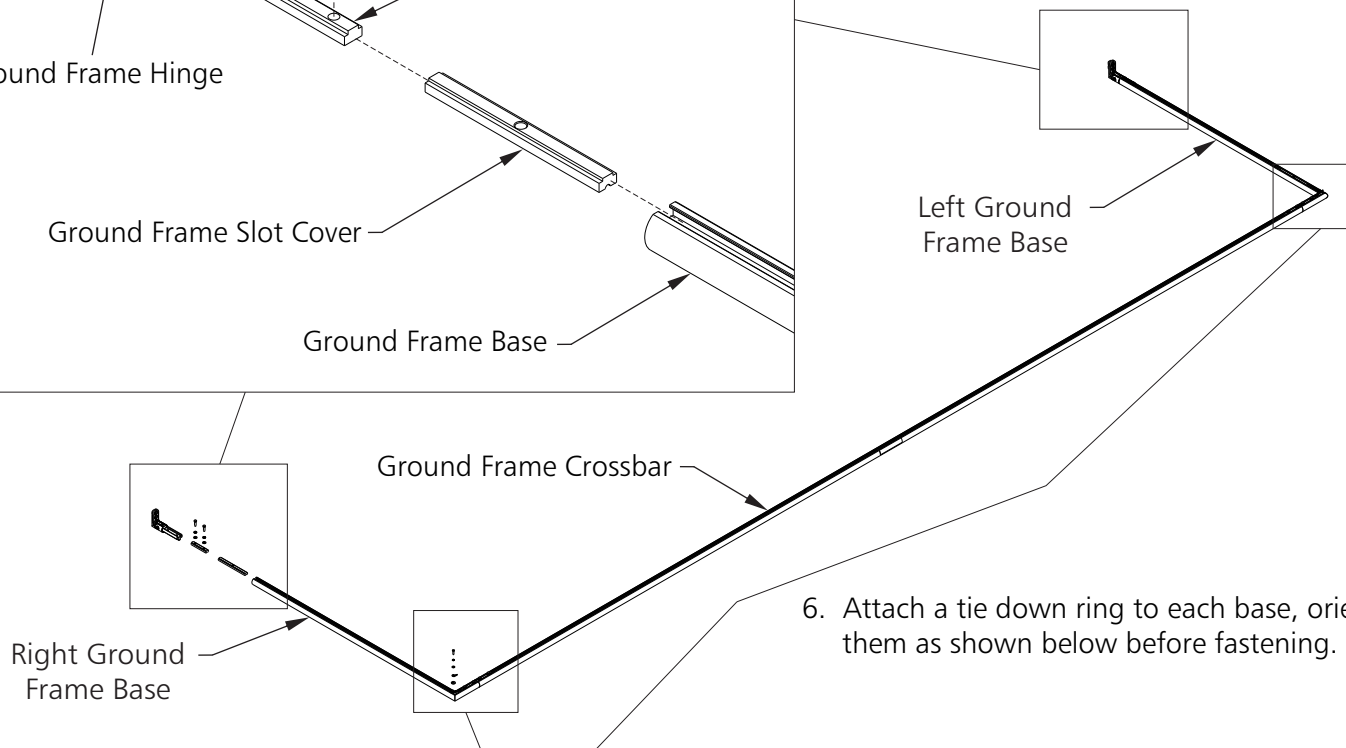

6. Attach a tie down ring to each base, orienting them as shown below before fastening.

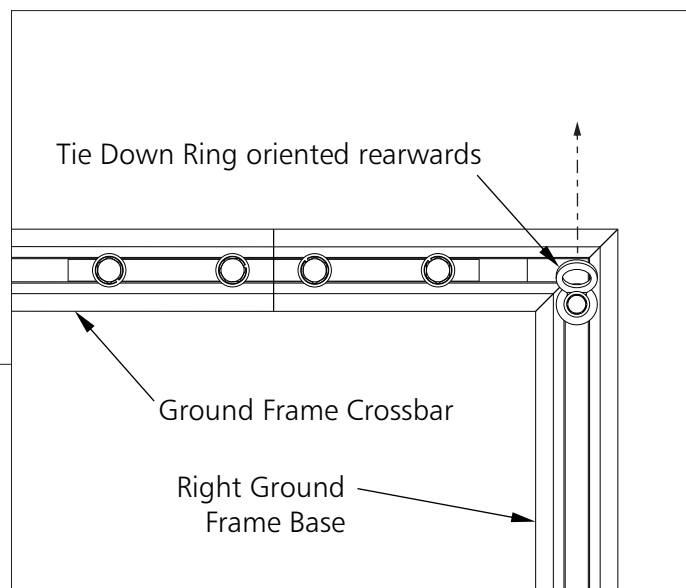
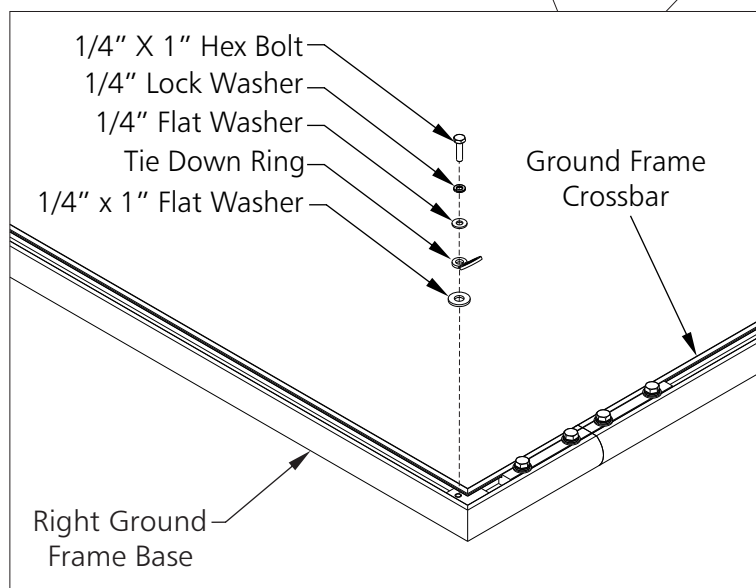

CAUTION

This goal has been designed to be used for the game of soccer only. Goal posts must be anchored AT ALL TIMES and shall be secured against overturning. Do not climb on the net or goal framework at any time! All fastenings must be checked to insure they are fully tightened before and after each use of this product. Goal posts not in use must be disassembled and properly stored in a safe, secure area (See included Guidelines for Movable Soccer Goal Safety.). Assembled goal posts should not be left unattended. Remove nets when goals are not in use. Do not use this equipment during the threat of high winds. Goal posts should be checked for safety before and after each use. All warning and safety labels included with this product must be visible at all times. Any modifications to this or any Kwik Goal product will void any and all warranties.

- ## OVERHEAD VIEW

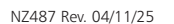

8. Dig the holes in the locations marked in the previous step large enough to accommodate the ground sleeves and anchors as shown below.
9. Fill the bottom of each hole with clean stone (1/4" - 3/4") [0.6cm - 2cm) to the levels shown to allow for water drainage. Hand tamp to create a flat base.

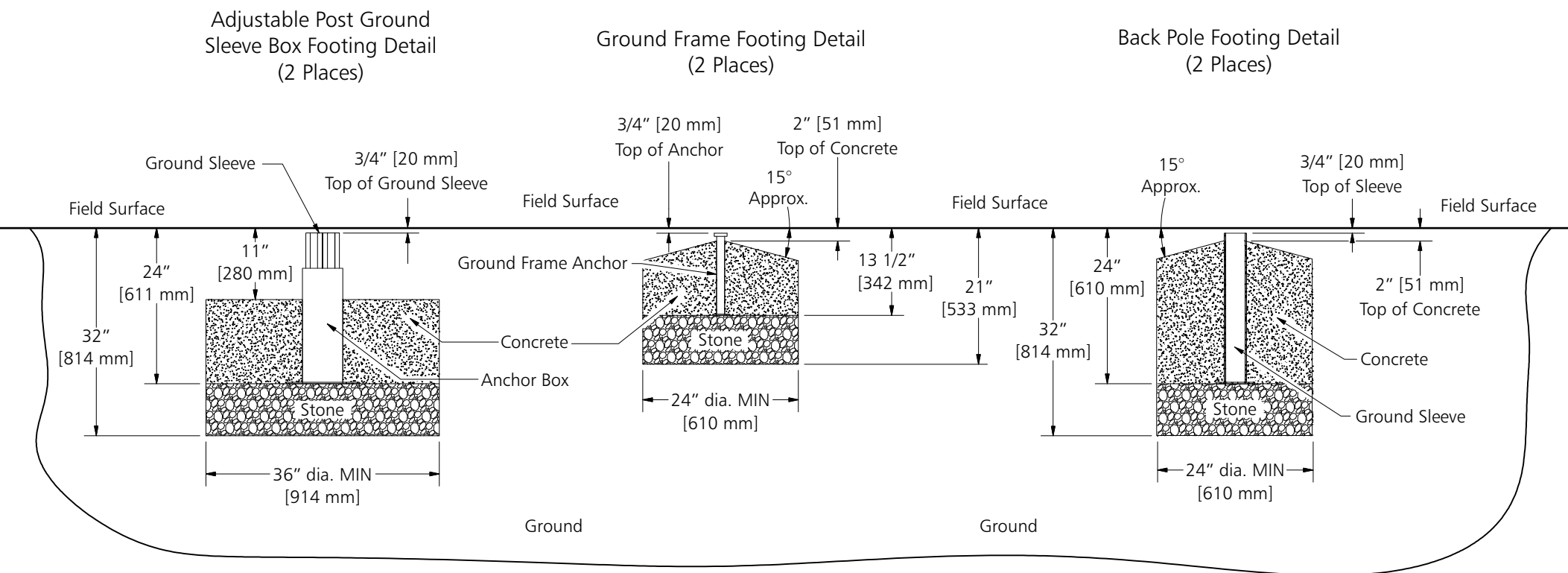

NOTE: THE ADJUSTABLE GROUND SLEEVE BOX AND HEIGHT ADJUSTABLE GOAL POSTS ARE PRECISE TOOLS USED TO MAKE GOAL FRAME ADJUSTMENTS QUICKLY AND EASILY. THESE TOOLS CAN BE DAMAGED BY IMPROPER USE, ADJUSTMENT, OR BY APPLYING EXCESSIVE FORCE. BE SURE ALL PERSONNEL HANDLING GOALS AND ADJUSTMENTS HAVE READ AND UNDERSTAND THESE INSTRUCTIONS COMPLETELY.

*****CAUTION*****

This goal has been designed to be used for the game of soccer only. Goal posts must be anchored AT ALL TIMES and shall be secured against overturning. Do not climb on the net or goal framework at any time! All fastenings must be checked to insure they are fully tightened before and after each use of this product. Goal posts not in use must be disassembled and properly stored in a safe, secure area (See included Guidelines for Movable Soccer Goal Safety.). Assembled goal posts should not be left unattended. Remove nets when goals are not in use. Do not use this equipment during the threat of high winds. Goal posts should be checked for safety before and after each use. All warning and safety labels included with this product must be visible at all times.

Any modifications to this or any Kwik Goal product will void any and all warranties.

10. Before placing the adjustable ground sleeve boxes in the ground, apply masking tape to the drainage holes on the bottom of the boxes to prevent concrete seepage into box. Identify the left and right adjustable ground sleeves boxes by checking the orientation of the tilt adjustment screw shaft, which must always angle towards the outside of the goal.

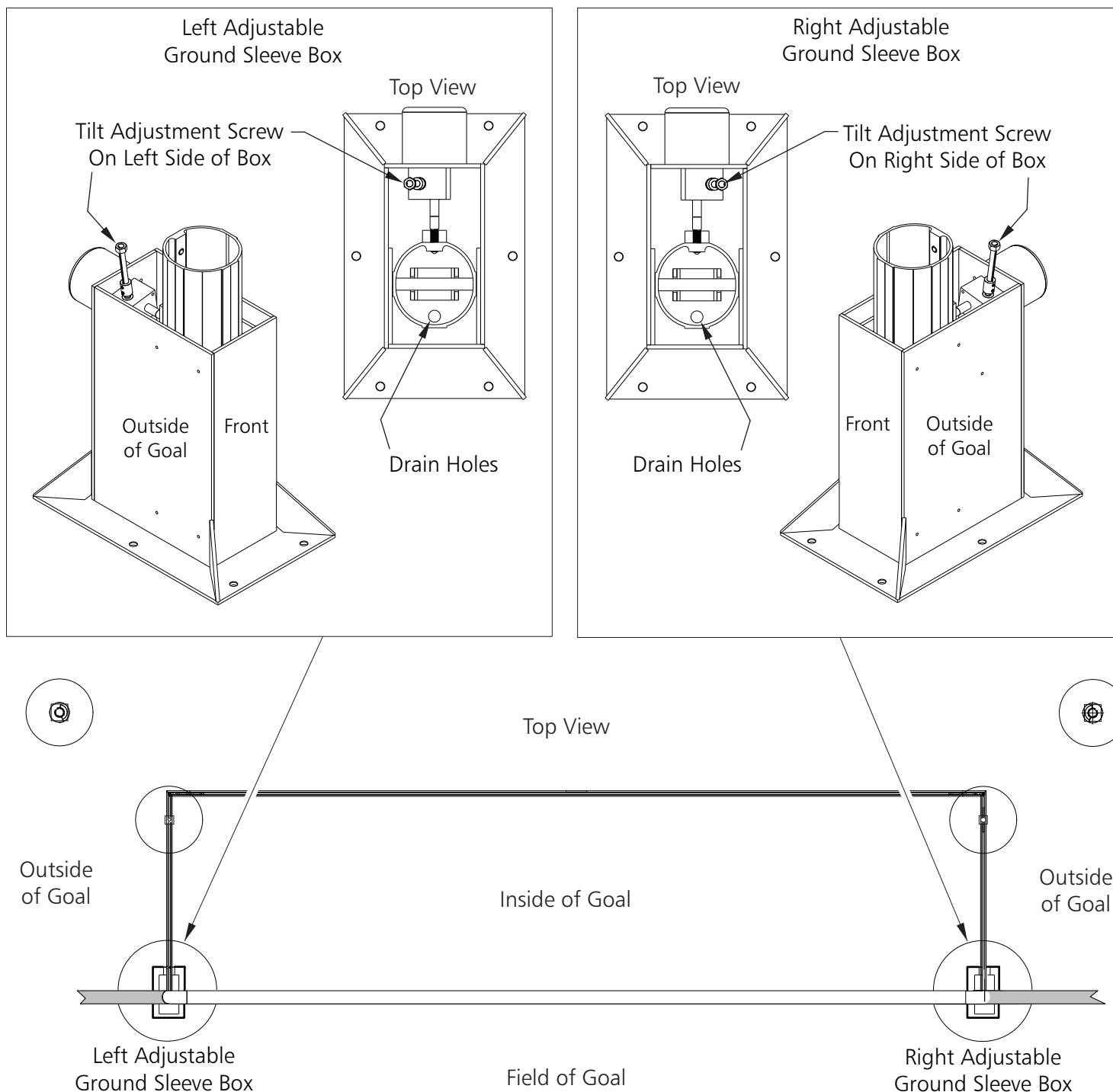

CAUTION

This goal has been designed to be used for the game of soccer only. Goal posts must be anchored AT ALL TIMES and shall be secured against overturning. Do not climb on the net or goal framework at any time! All fastenings must be checked to insure they are fully tightened before and after each use of this product. Goal posts not in use must be disassembled and properly stored in a safe, secure area (See included Guidelines for Movable Soccer Goal Safety.). Assembled goal posts should not be left unattended. Remove nets when goals are not in use. Do not use this equipment during the threat of high winds. Goal posts should be checked for safety before and after each use.

All warning and safety labels included with this product must be visible at all times.

Any modifications to this or any Kwik Goal product will void any and all warranties.

11. Check that the ground sleeve tilt adjustment in each ground sleeve box is in the neutral position by aligning the center of the ground sleeve with the neutral mark on the rim of the box. If needed, adjust the sleeve using the supplied socket driver and 11/16" socket by following the guide below.

NOTE: ONCE SET DO NOT ADJUST GROUND SLEEVE UNTIL INSTALLATION IS COMPLETE

NOTE: ONLY MAKE GOAL ADJUSTMENTS USING INCLUDED SOCKET DRIVER,
DO NOT USE POWER TOOLS, RATCHETS, OR OTHER HIGH-LEVERAGE TOOLS

Left Sleeve Tilt Adjustment:
Clockwise - Tilt Forward
Counter-Clockwise - Tilt Rearward

Right Sleeve Tilt Adjustment:
Clockwise - Tilt Rearward
Counter-Clockwise - Tilt Forward

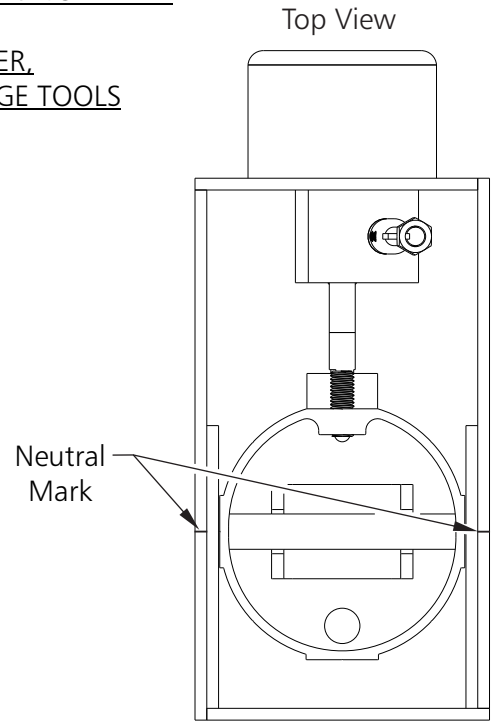
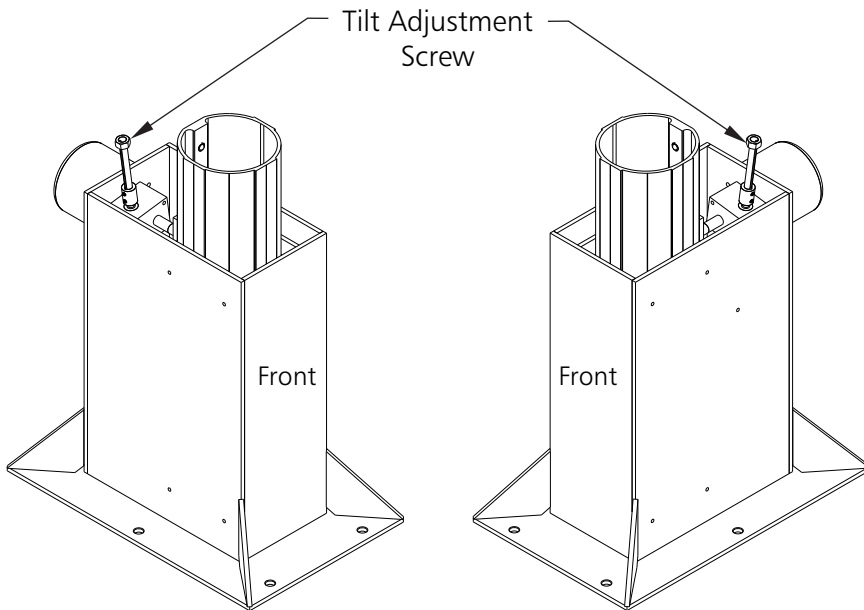

Front View

3/4" [20 mm]

Field Surface

Adjustable Ground Sleeve Box

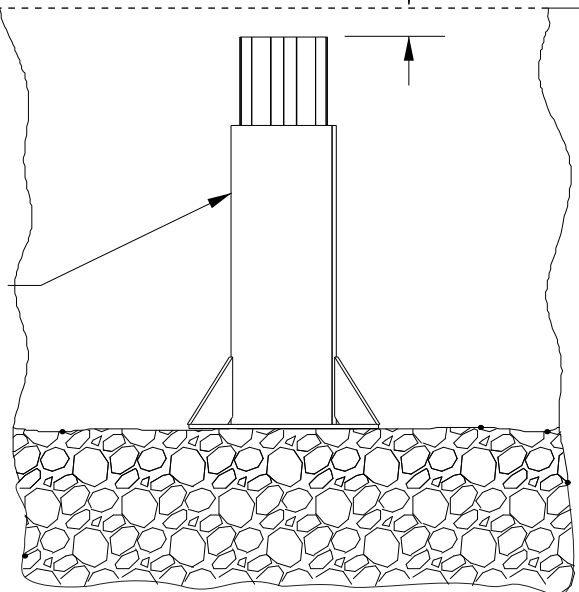

12. Place the adjustable ground sleeve boxes in the ground. Double check that the top of the sleeves are 3/4" [20 mm] below of field surface, and add/remove stone as needed to correct their positions.

*****CAUTION*****

This goal has been designed to be used for the game of soccer only. Goal posts must be anchored AT ALL TIMES and shall be secured against overturning. Do not climb on the net or goal framework at any time! All fastenings must be checked to insure they are fully tightened before and after each use of this product. Goal posts not in use must be disassembled and properly stored in a safe, secure area (See included Guidelines for Movable Soccer Goal Safety.). Assembled goal posts should not be left unattended. Remove nets when goals are not in use. Do not use this equipment during the threat of high winds. Goal posts should be checked for safety before and after each use.

All warning and safety labels included with this product must be visible at all times.

Any modifications to this or any Kwik Goal product will void any and all warranties.

13. Check that the posts' height adjustment is in the neutral position by measuring 2" [51 mm] between the bottom of the post and the bottom of the height adjustment sleeve. If necessary, adjust the height adjustment sleeve using the supplied socket driver and 8mm socket by following the guide below.

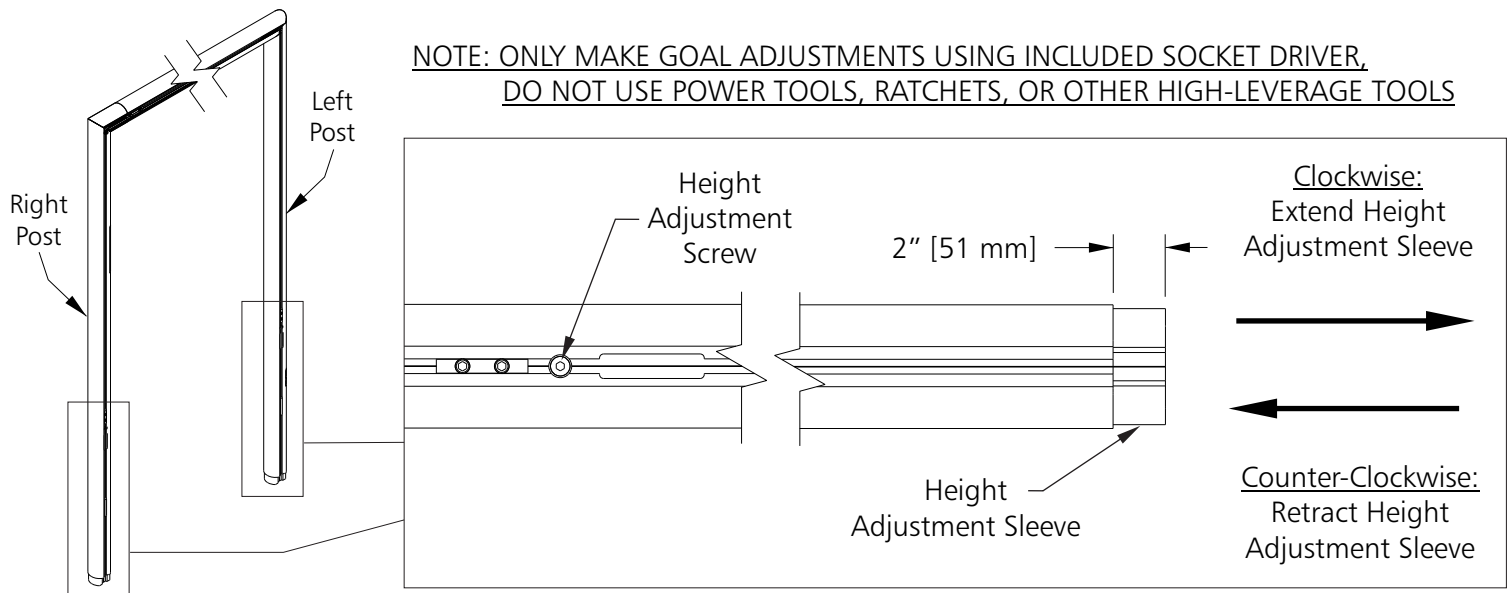

14. Place a 12-16 gallon heavy duty trash bag over each ground sleeve box and cut a hole for the goal posts to pass through, and use masking tape to tape over the drainage hole on the backpole ground sleeves to prevent concrete seepage into sleeves.
15. Insert the assembled goal posts into the adjustable ground sleeve boxes in the ground, passing the posts through the holes in the trash bags. Place the back pole ground sleeves and backpoles in the ground. Brace back poles to prevent them from falling over before concrete is poured. Make sure the goal is centered in the field with the face of the goal flush with the goal line.

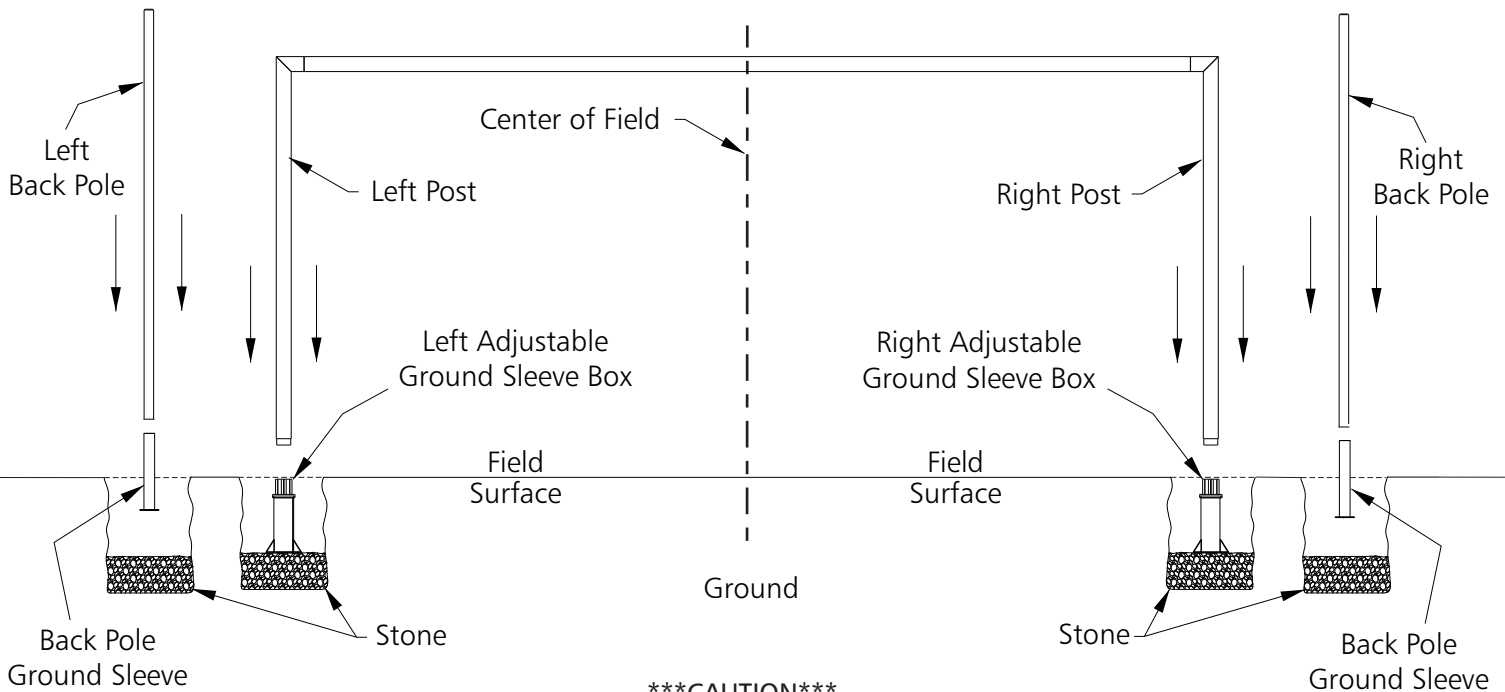

*****CAUTION*****

This goal has been designed to be used for the game of soccer only. Goal posts must be anchored AT ALL TIMES and shall be secured against overturning. Do not climb on the net or goal framework at any time! All fastenings must be checked to insure they are fully tightened before and after each use of this product. Goal posts not in use must be disassembled and properly stored in a safe, secure area (See included Guidelines for Movable Soccer Goal Safety.). Assembled goal posts should not be left unattended. Remove nets when goals are not in use. Do not use this equipment during the threat of high winds. Goal posts should be checked for safety before and after each use.

All warning and safety labels included with this product must be visible at all times.

Any modifications to this or any Kwik Goal product will void any and all warranties.

16. Tighten the set screw on the ground sleeve until it is snug enough against the post to prevent excess post movement in the sleeve, but still loose enough to allow the post to be lifted in/out.

NOTE: DO NOT OVER TIGHTEN. This will lock the post in place and disable the height adjustment.

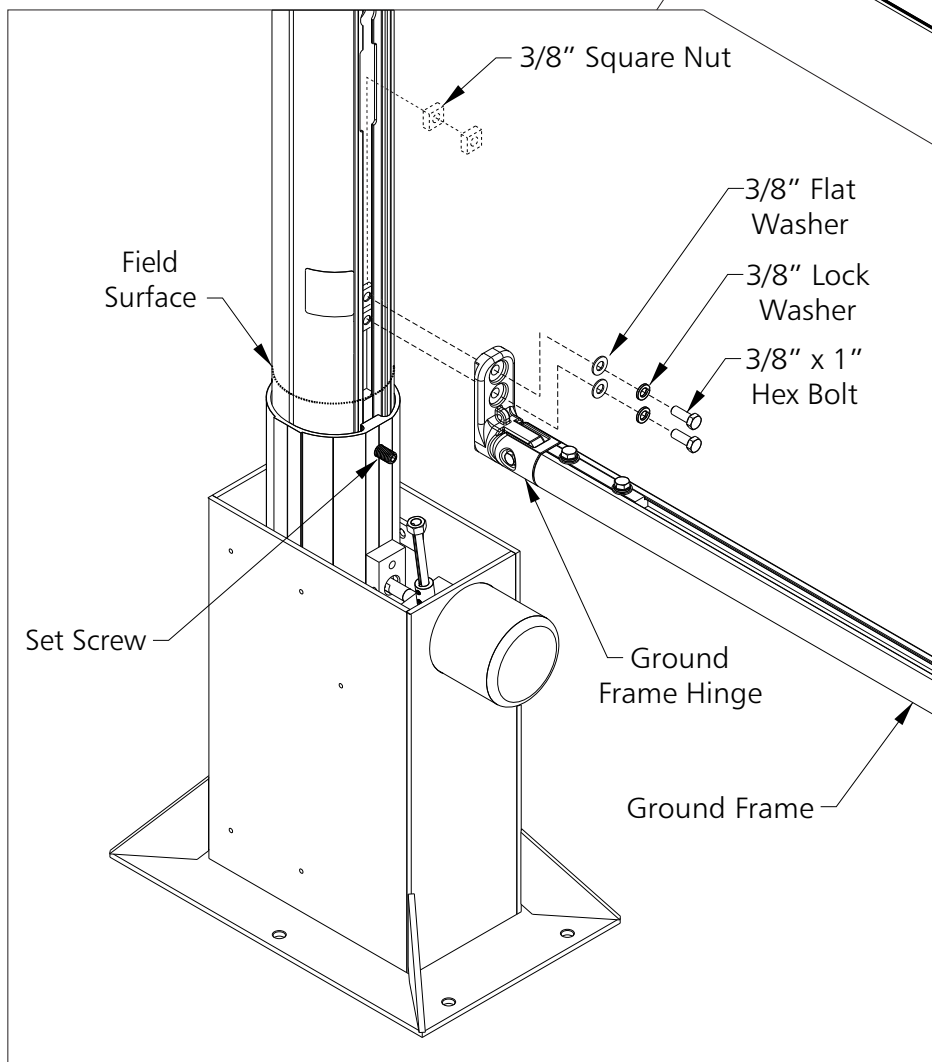

17. Install the assembled ground frame onto the goal as shown to the left. The square nuts can be inserted into the net channel through the opening located 1-2 feet above the field surface. Alternatively, the square nuts can be loosely installed onto the ground frame hinge and then inserted into the slot before sliding the entire frame down into place.

*****CAUTION*****

This goal has been designed to be used for the game of soccer only. Goal posts must be anchored AT ALL TIMES and shall be secured against overturning. Do not climb on the net or goal framework at any time! All fastenings must be checked to insure they are fully tightened before and after each use of this product. Goal posts not in use must be disassembled and properly stored in a safe, secure area (See included Guidelines for Movable Soccer Goal Safety.). Assembled goal posts should not be left unattended. Remove nets when goals are not in use. Do not use this equipment during the threat of high winds. Goal posts should be checked for safety before and after each use. All warning and safety labels included with this product must be visible at all times. Any modifications to this or any Kwik Goal product will void any and all warranties.

18. Attach the ground frame anchors to the ground frame as shown below, passing the anchor bolt through the ground frame slot covers and slots in each base. Position the anchor in the middle of the slot. Ensure that the top of the anchor remains 3/4" [20 mm] below the field surface by using the ground frame anchor spacer.

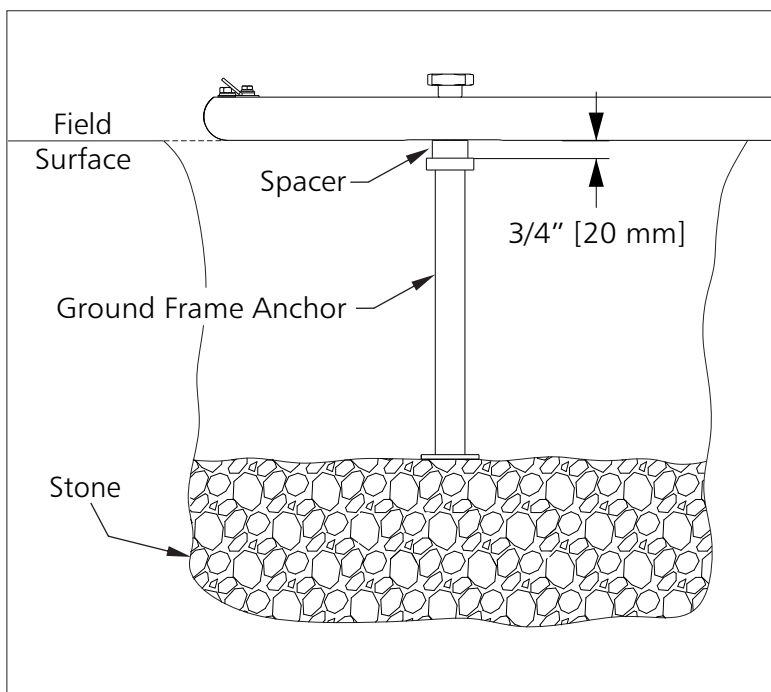
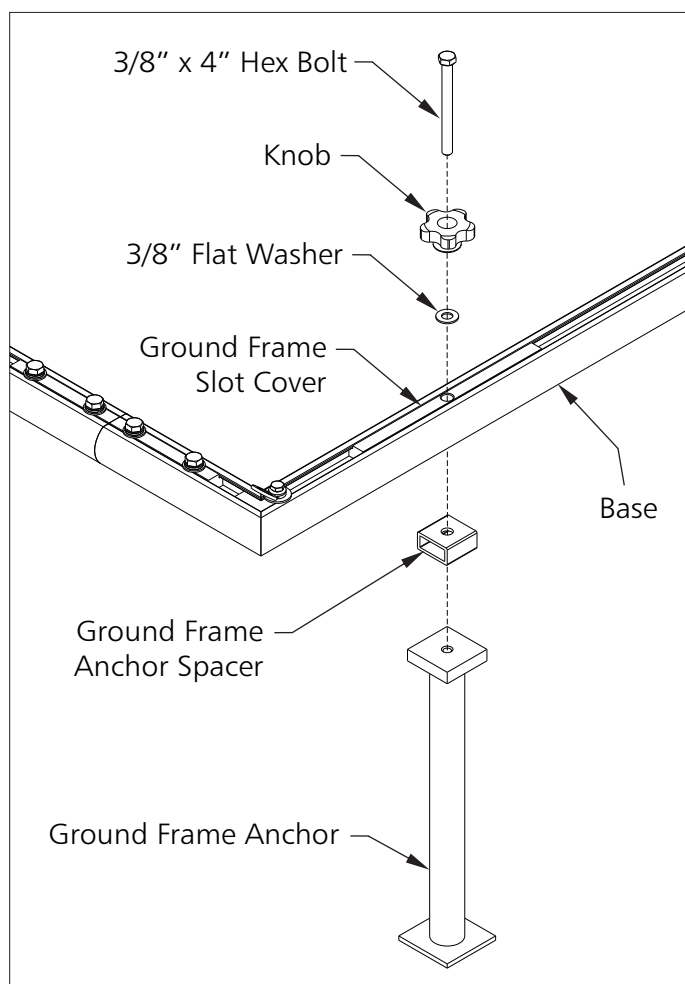
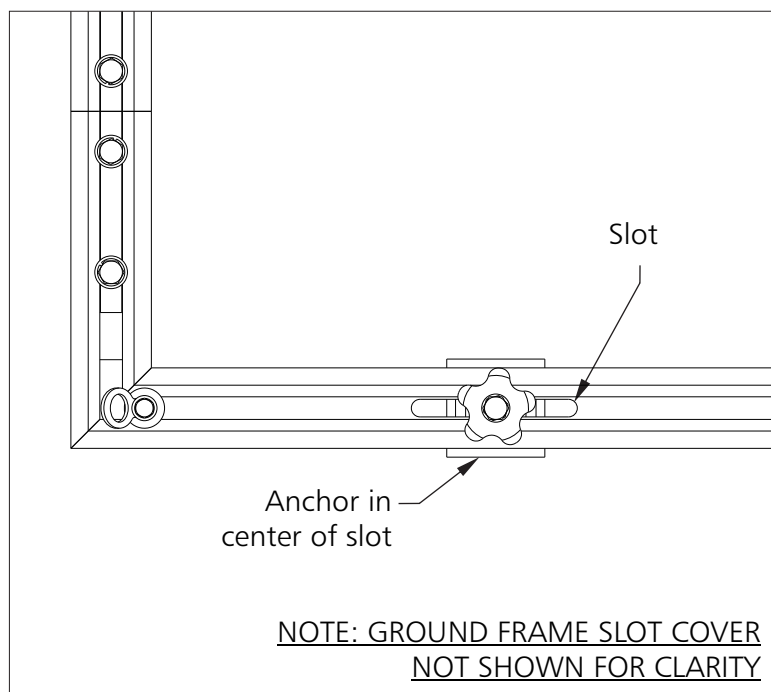
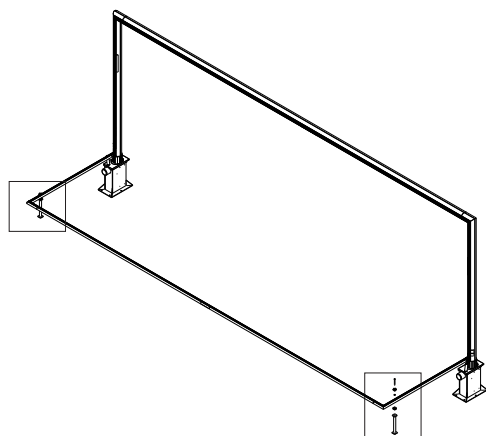

*****CAUTION*****

This goal has been designed to be used for the game of soccer only. Goal posts must be anchored AT ALL TIMES and shall be secured against overturning. Do not climb on the net or goal framework at any time! All fastenings must be checked to insure they are fully tightened before and after each use of this product. Goal posts not in use must be disassembled and properly stored in a safe, secure area (See included Guidelines for Movable Soccer Goal Safety.). Assembled goal posts should not be left unattended. Remove nets when goals are not in use. Do not use this equipment during the threat of high winds. Goal posts should be checked for safety before and after each use. All warning and safety labels included with this product must be visible at all times. Any modifications to this or any Kwik Goal product will void any and all warranties.

19. Plumb/level the entire goal following steps 19a and 19b. These steps must be done together to ensure all parts of the goal are equally plumb/level.

NOTE: DO NOT USE THE POST HEIGHT ADJUSTMENTS OR GROUND SLEEVE TILT ADJUSTMENTS TO HELP PLUMB/LEVEL GOAL. ANY ADJUSTMENTS MADE TO HEIGHT OR TILT SHOULD BE DONE WITH STONE IN THE BOTTOM OF THE ANCHOR HOLE ONLY.

- 19a. Make sure the posts are exactly 24'-3/16" [7320 mm] apart at the bottom, that the crossbar is 8'0" [2438 mm] above field surface and level, and that the face of the goal post is flush with the goal line. Add/remove stone as needed to correct their positions, ensuring all ground sleeves remain 3/4" [20 mm] below the field surface.

NOTE: DO NOT USE THE GROUND SLEEVE TILT OR POST HEIGHT ADJUSTMENTS TO HELP PLUMB/LEVEL GOAL.

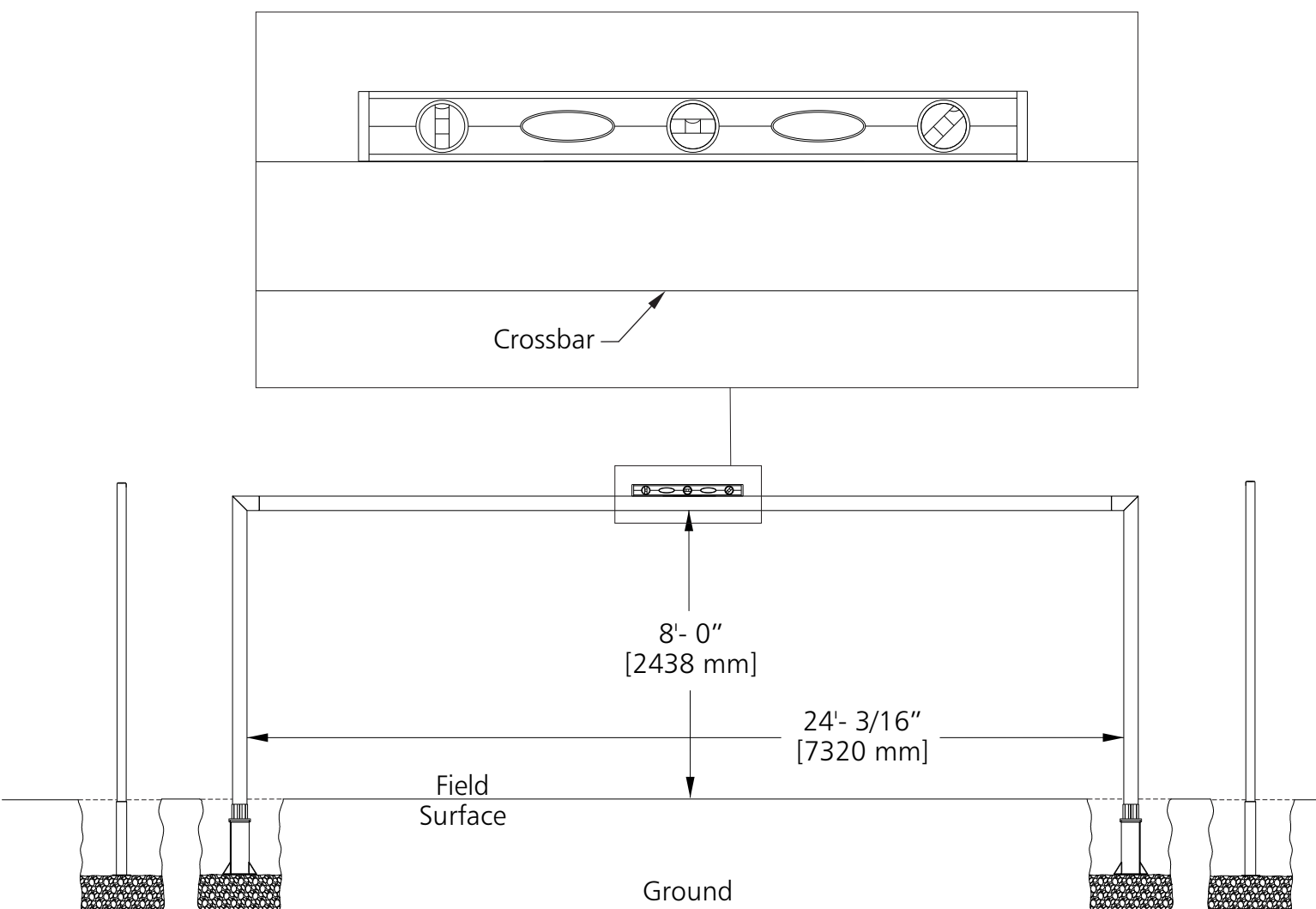

CAUTION

This goal has been designed to be used for the game of soccer only. Goal posts must be anchored AT ALL TIMES and shall be secured against overturning. Do not climb on the net or goal framework at any time! All fastenings must be checked to insure they are fully tightened before and after each use of this product. Goal posts not in use must be disassembled and properly stored in a safe, secure area (See included Guidelines for Movable Soccer Goal Safety.). Assembled goal posts should not be left unattended. Remove nets when goals are not in use. Do not use this equipment during the threat of high winds. Goal posts should be checked for safety before and after each use.

All warning and safety labels included with this product must be visible at all times.

Any modifications to this or any Kwik Goal product will void any and all warranties.

- 19b. Check that the adjustable ground sleeve boxes are plumb by leveling them side to side and front to back. Add/remove stone as needed to correct their positions.

NOTE: DO NOT USE THE GROUND SLEEVE TILT OR POST HEIGHT ADJUSTMENTS TO HELP PLUMB/LEVEL GOAL.

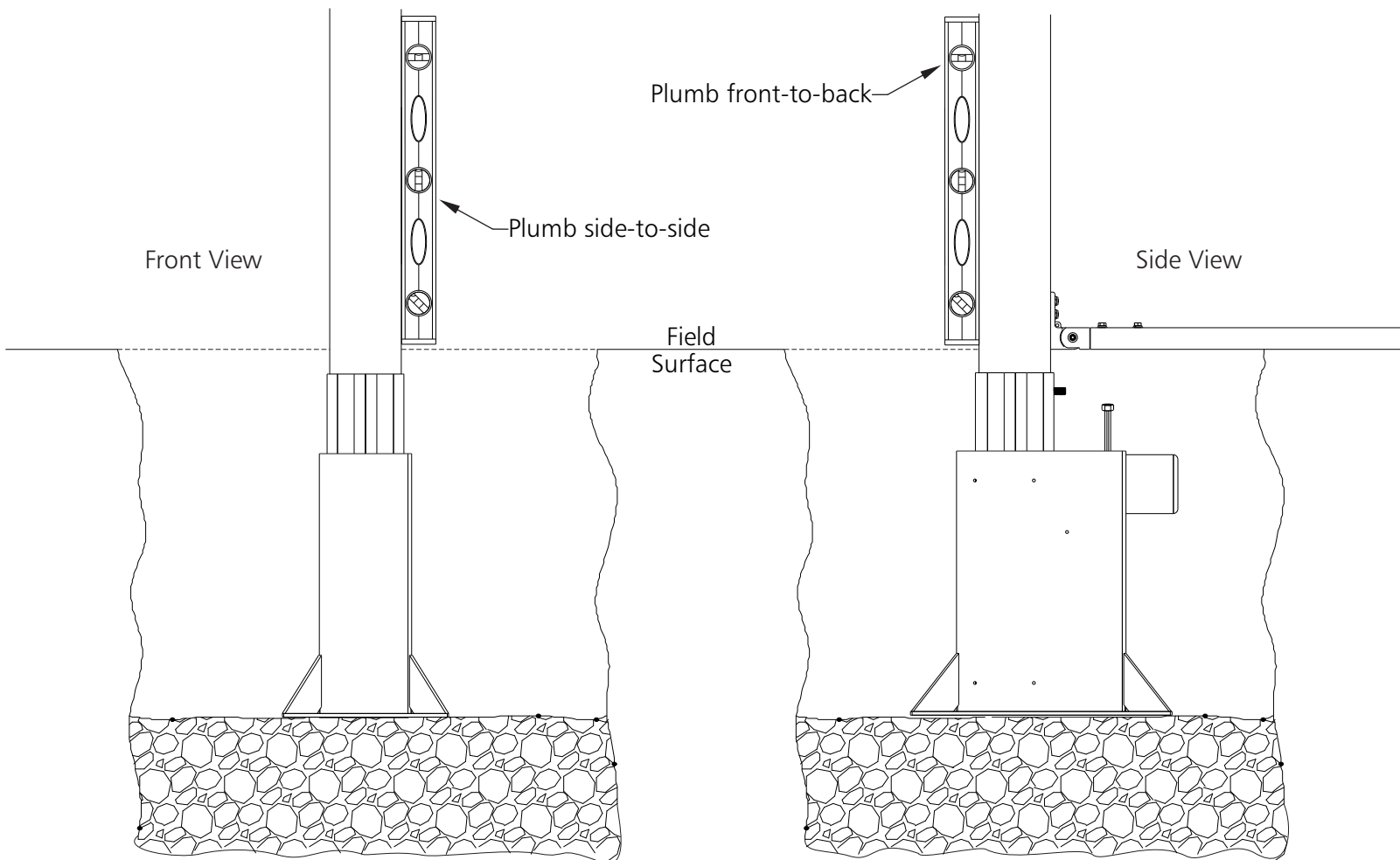

20. Before pouring concrete, seal open areas by wrapping the posts, back poles, ground frame, and top of the ground sleeve boxes with plastic wrap, tape, or any other suitable barrier at ground level to protect the parts from concrete while pouring. Secure the trash bag and any plastic/wrap used in place above the concrete line shown in step 9.

NOTE: FAILURE TO PROTECT COMPONENTS WHILE POURING CONCRETE MAY CAUSE DAMAGE TO THE GOAL.

21. Fill the holes with concrete to the levels shown in steps 8-9. While pouring concrete, agitate the concrete to relieve air for a better foundation, and make sure posts and back poles stay plumb. After the concrete has fully cured, see step 22 for test procedures to ensure the goal has been anchored properly.

NOTE: THE FLOWING CONCRETE WILL CAUSE PARTS TO SHIFT IF NOT PROPERLY HELD IN PLACE.

*****CAUTION*****

This goal has been designed to be used for the game of soccer only. Goal posts must be anchored AT ALL TIMES and shall be secured against overturning. Do not climb on the net or goal framework at any time! All fastenings must be checked to insure they are fully tightened before and after each use of this product. Goal posts not in use must be disassembled and properly stored in a safe, secure area (See included Guidelines for Movable Soccer Goal Safety.). Assembled goal posts should not be left unattended. Remove nets when goals are not in use. Do not use this equipment during the threat of high winds. Goal posts should be checked for safety before and after each use.

All warning and safety labels included with this product must be visible at all times.

Any modifications to this or any Kwik Goal product will void any and all warranties.

22. After installing, test as described below to verify effectiveness of anchor system. If applicable, allow concrete to fully cure before testing.

ANCHOR TEST

1. Clear all persons from a minimum 50 foot radius surrounding the goal.
2. Verify goal is attached to anchors according to instruction.
3. Apply a horizontal pull force of 248 lbs. to the center of the crossbar for 60 - 70 seconds.
Full safety precautions must be taken while performing test.
4. If goal overturns during application of force or does not return to an upright position after removing force, an alternate anchoring system must be used

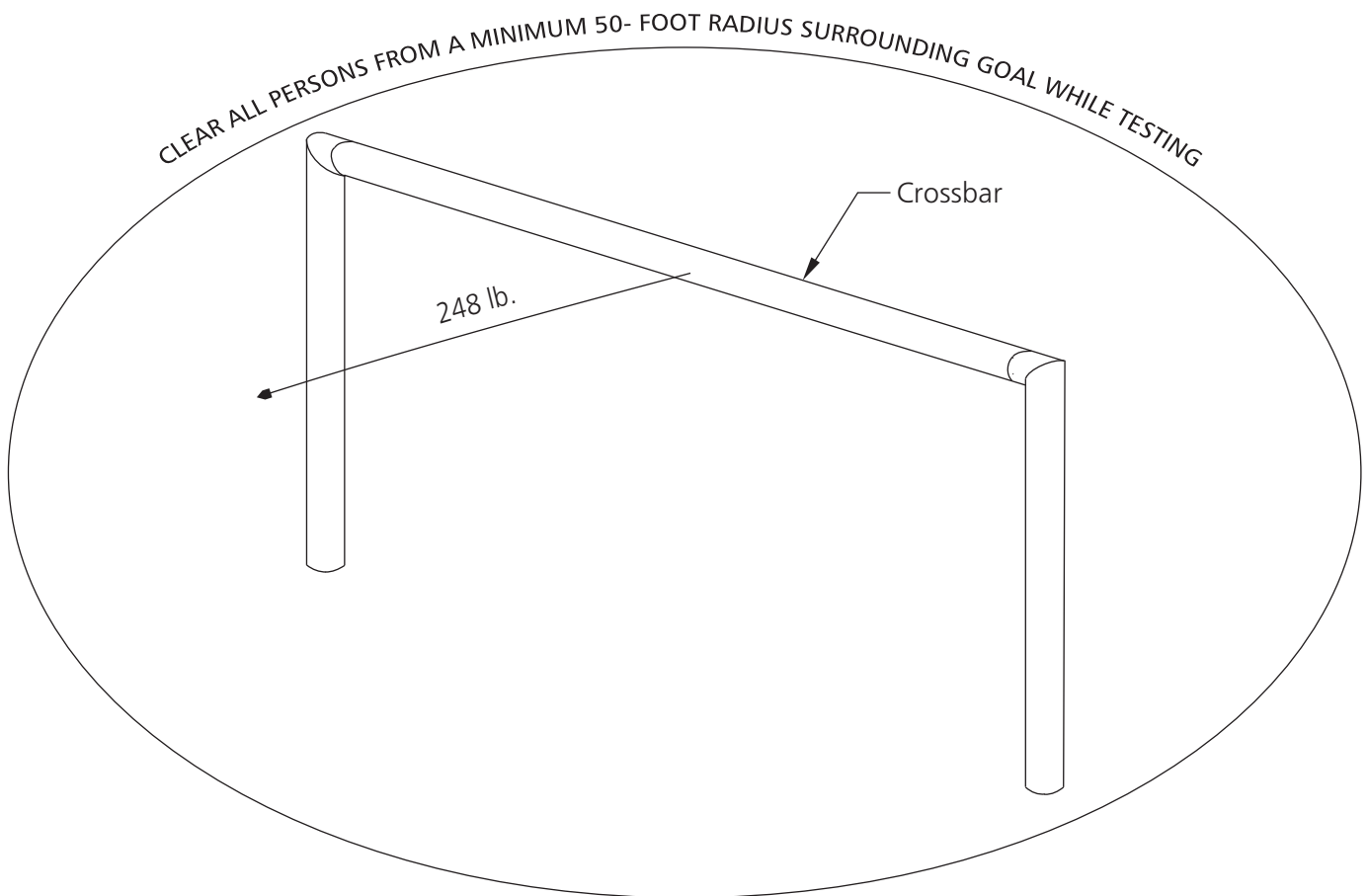

CAUTION

This goal has been designed to be used for the game of soccer only. Goal posts must be anchored AT ALL TIMES and shall be secured against overturning. Do not climb on the net or goal framework at any time! All fastenings must be checked to insure they are fully tightened before and after each use of this product. Goal posts not in use must be disassembled and properly stored in a safe, secure area (See included Guidelines for Movable Soccer Goal Safety.). Assembled goal posts should not be left unattended. Remove nets when goals are not in use. Do not use this equipment during the threat of high winds. Goal posts should be checked for safety before and after each use.

All warning and safety labels included with this product must be visible at all times.

Any modifications to this or any Kwik Goal product will void any and all warranties.

23. Create a cutout for the ground sleeve on each of the plastic barriers by placing a ground sleeve box slide cap centered over top of the plastic barrier, and then using the opening of slide cap as a guide to cut the plastic barrier with a utility knife.

NOTE: Making the cutout slightly smaller than the opening of the cap creates a better, tighter fit.

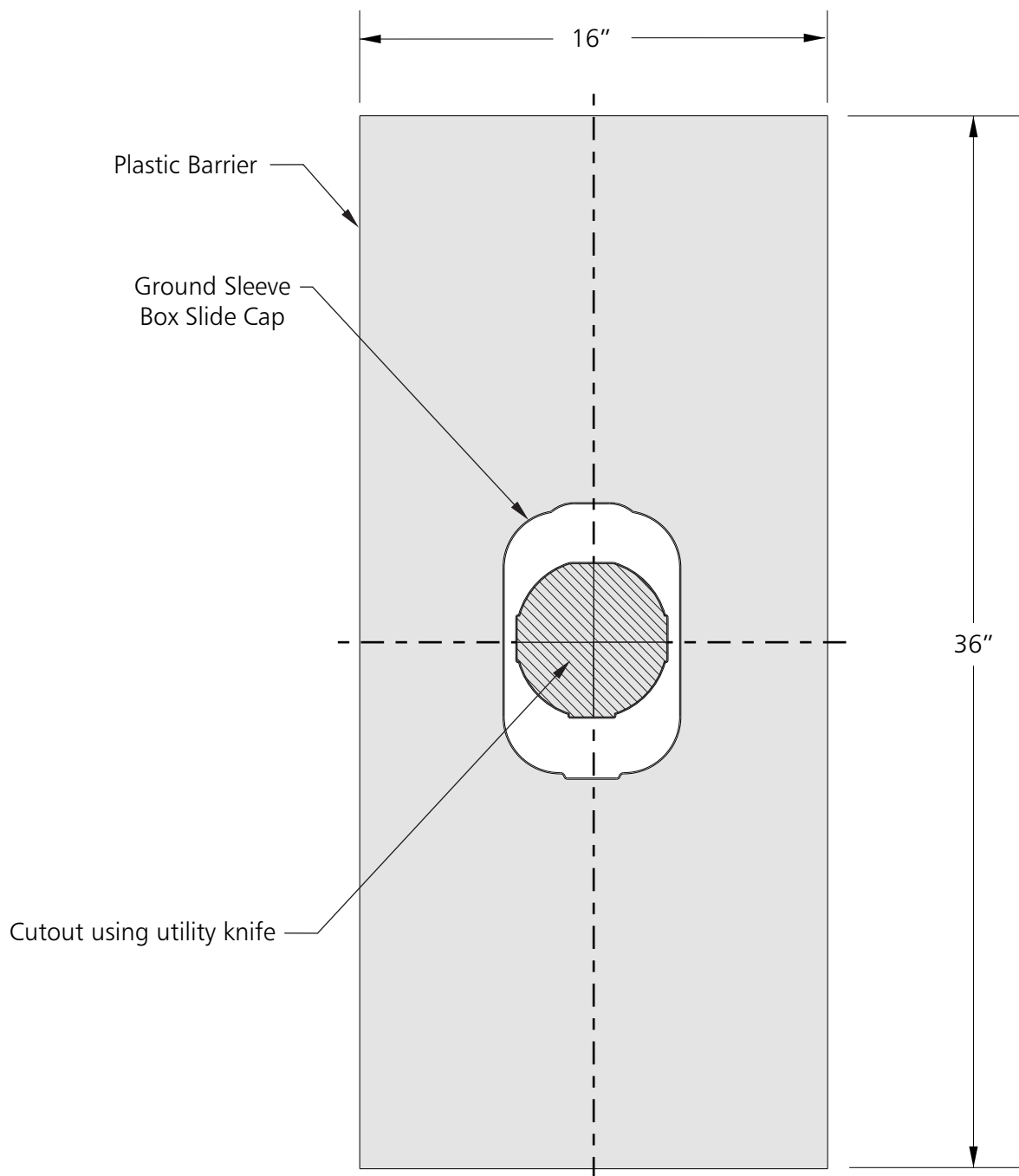

CAUTION

This goal has been designed to be used for the game of soccer only. Goal posts must be anchored AT ALL TIMES and shall be secured against overturning. Do not climb on the net or goal framework at any time! All fastenings must be checked to insure they are fully tightened before and after each use of this product. Goal posts not in use must be disassembled and properly stored in a safe, secure area (See included Guidelines for Movable Soccer Goal Safety.). Assembled goal posts should not be left unattended. Remove nets when goals are not in use. Do not use this equipment during the threat of high winds. Goal posts should be checked for safety before and after each use.

All warning and safety labels included with this product must be visible at all times.

Any modifications to this or any Kwik Goal product will void any and all warranties.

24. Once concrete has set, remove all protective plastic from all components and remove the goal frame from the ground sleeves. Use a rod to punch out the masking tape put over the drainage holes on each anchor to allow for drainage.
25. Install the box caps on each of the adjustable ground sleeve boxes as shown below. It may be necessary to temporarily remove the set screw on the ground sleeve to install the sliding cap.

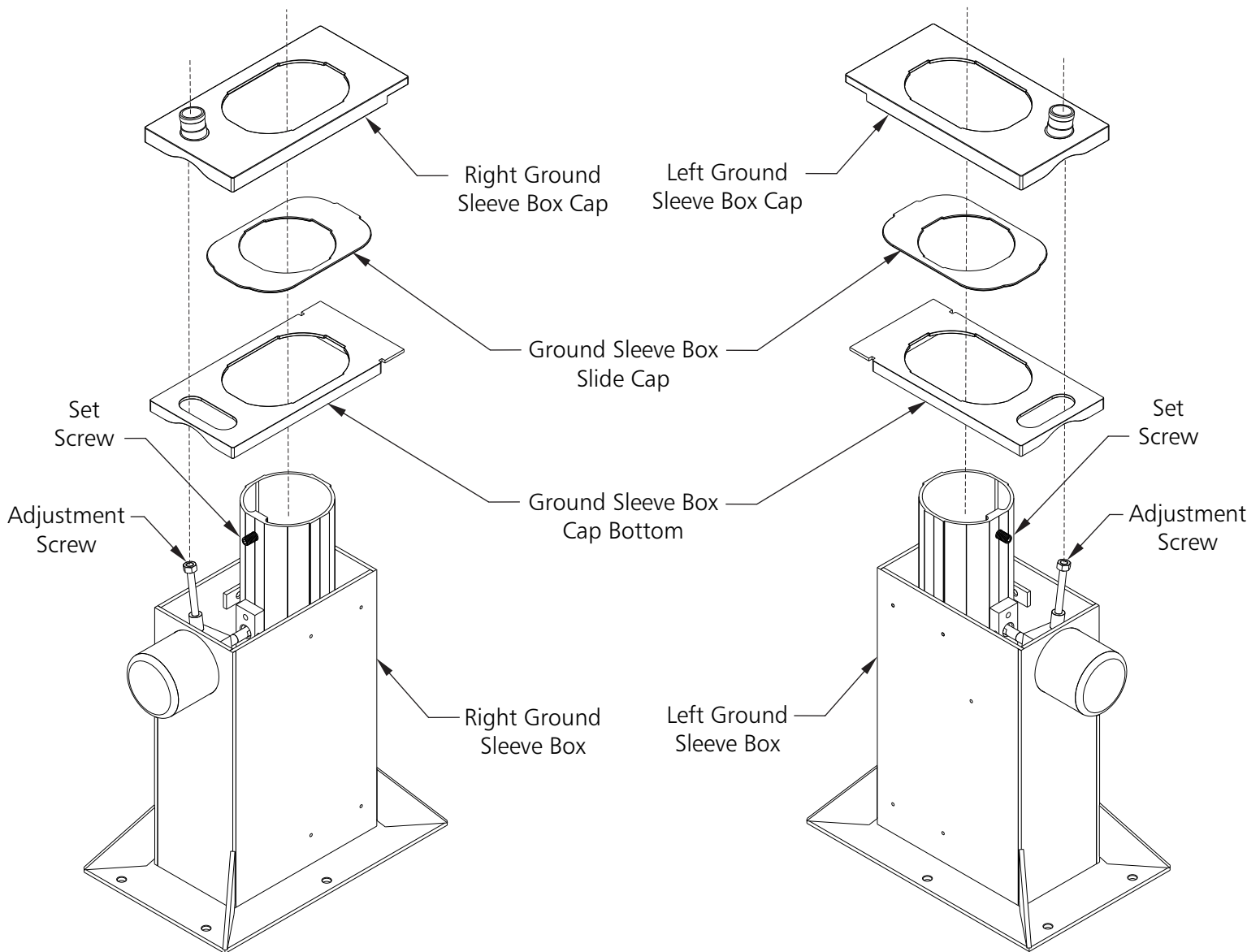

*****CAUTION*****

This goal has been designed to be used for the game of soccer only. Goal posts must be anchored AT ALL TIMES and shall be secured against overturning. Do not climb on the net or goal framework at any time! All fastenings must be checked to insure they are fully tightened before and after each use of this product. Goal posts not in use must be disassembled and properly stored in a safe, secure area (See included Guidelines for Movable Soccer Goal Safety.). Assembled goal posts should not be left unattended. Remove nets when goals are not in use. Do not use this equipment during the threat of high winds. Goal posts should be checked for safety before and after each use. All warning and safety labels included with this product must be visible at all times. Any modifications to this or any Kwik Goal product will void any and all warranties.

26. Install the plastic barrier over the top of each box and box cap. Use a utility knife to cut a small X to push the adjustment screw through. Attach the included rubber tube to the cap using a plastic cable tie as shown below (Note: lightly wetting the inside of the rubber tubing may help slide it in place more easily). Once secure, cut off excess cable tie using scissors.

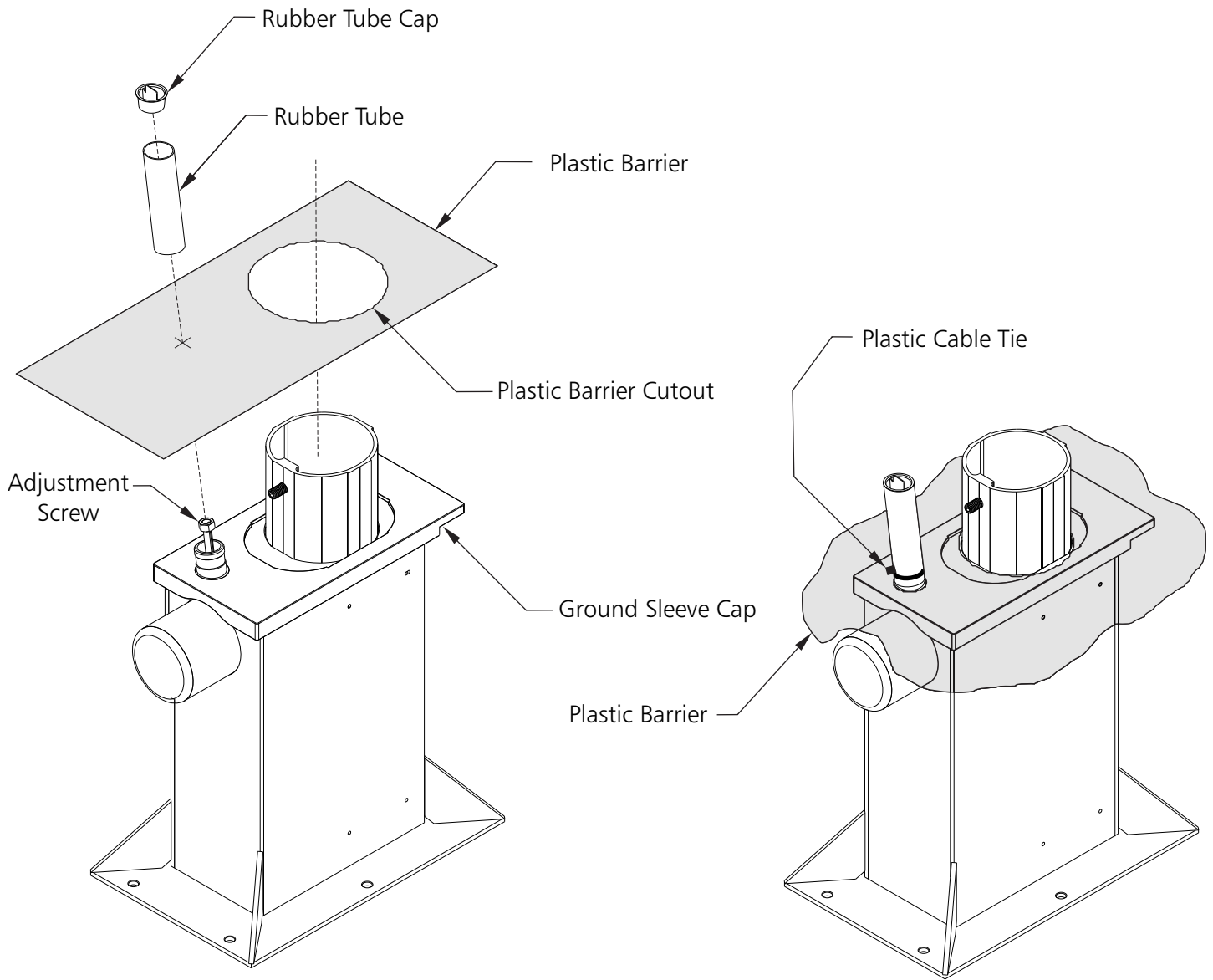

27. Once the cap, plastic barrier, and rubber tube are installed the goal can be re-inserted and the anchor holes can be back-filled. The rubber tube can be trimmed flush with the field surface if needed once the holes are backfilled.

CAUTION

This goal has been designed to be used for the game of soccer only. Goal posts must be anchored AT ALL TIMES and shall be secured against overturning. Do not climb on the net or goal framework at any time! All fastenings must be checked to insure they are fully tightened before and after each use of this product. Goal posts not in use must be disassembled and properly stored in a safe, secure area (See included Guidelines for Movable Soccer Goal Safety.). Assembled goal posts should not be left unattended. Remove nets when goals are not in use. Do not use this equipment during the threat of high winds. Goal posts should be checked for safety before and after each use.

All warning and safety labels included with this product must be visible at all times.

Any modifications to this or any Kwik Goal product will void any and all warranties.

28. Once concrete has set, remove all protective plastic from the back poles and remove them from the anchors. Use a rod to punch out the masking tape put over the drainage holes on each anchor to allow for drainage.
29. Assemble the right and left back poles as shown below. Take note that the net tension winches are positioned differently on each pole.

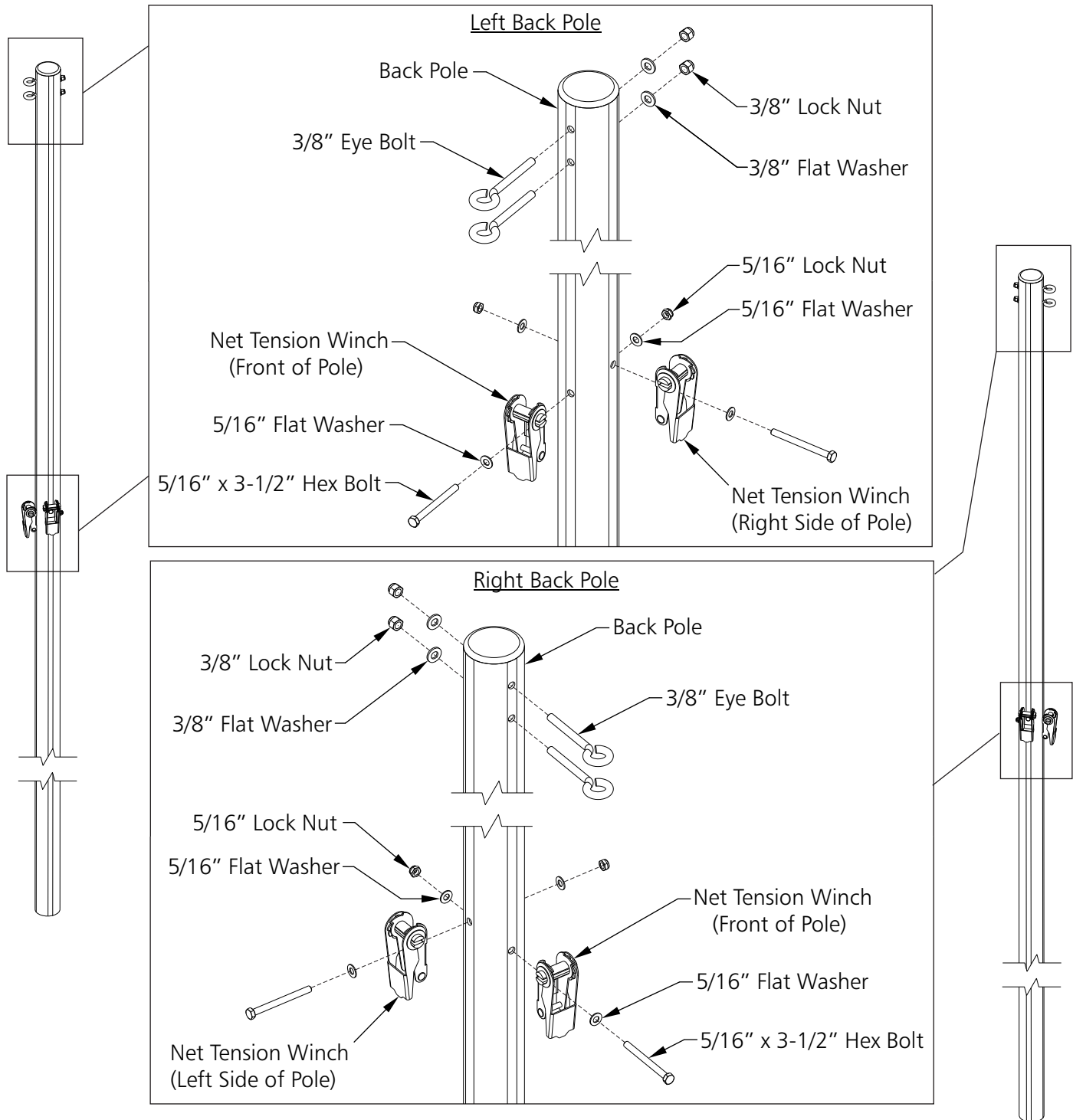

CAUTION

This goal has been designed to be used for the game of soccer only. Goal posts must be anchored AT ALL TIMES and shall be secured against overturning. Do not climb on the net or goal framework at any time! All fastenings must be checked to insure they are fully tightened before and after each use of this product. Goal posts not in use must be disassembled and properly stored in a safe, secure area (See included Guidelines for Movable Soccer Goal Safety.). Assembled goal posts should not be left unattended. Remove nets when goals are not in use. Do not use this equipment during the threat of high winds. Goal posts should be checked for safety before and after each use. All warning and safety labels included with this product must be visible at all times. Any modifications to this or any Kwik Goal product will void any and all warranties.

30. Assemble the net straps onto each back pole, passing them through the net tension winches and eye bolts as shown below.

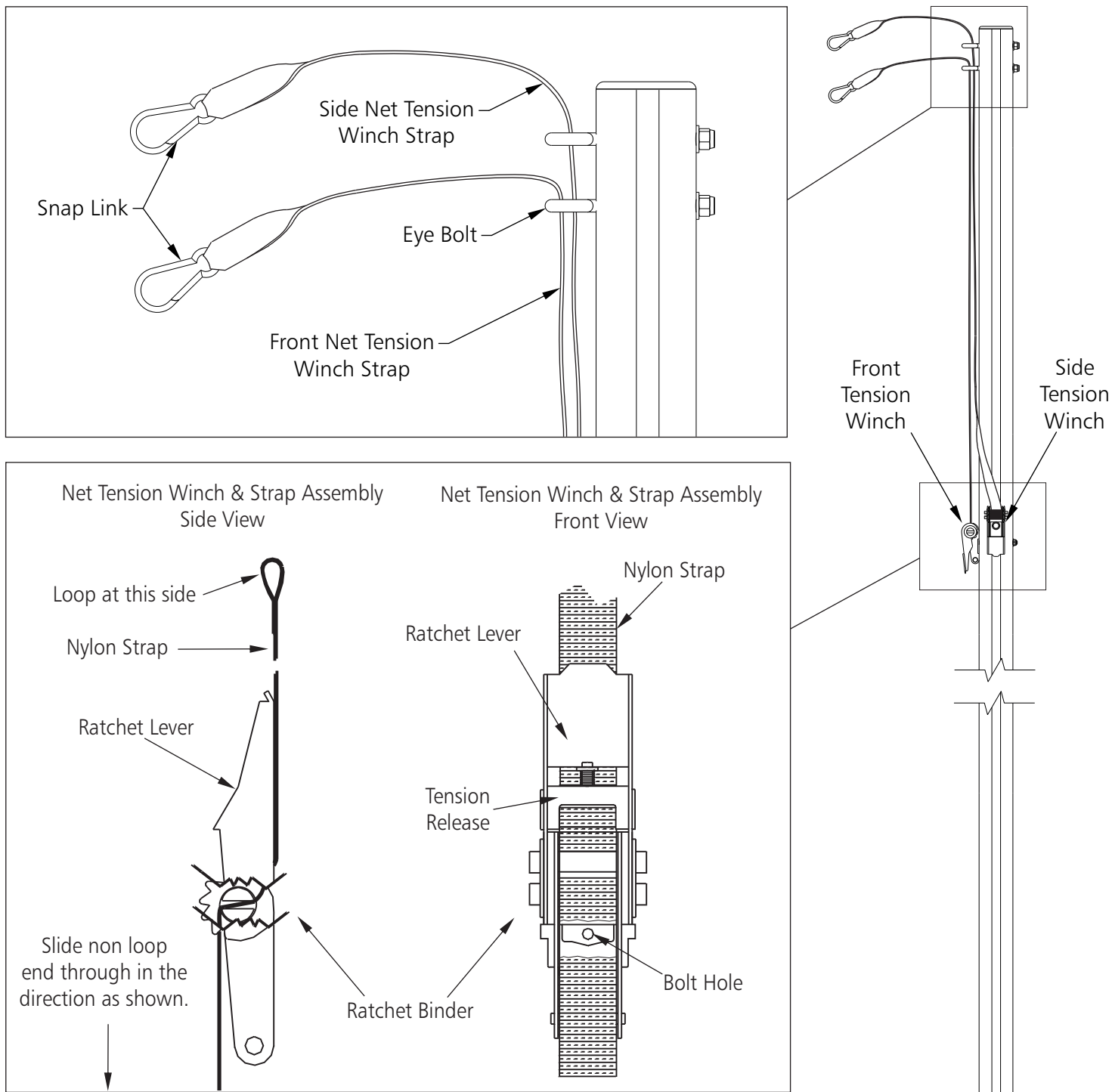

CAUTION

This goal has been designed to be used for the game of soccer only. Goal posts must be anchored AT ALL TIMES and shall be secured against overturning. Do not climb on the net or goal framework at any time! All fastenings must be checked to insure they are fully tightened before and after each use of this product. Goal posts not in use must be disassembled and properly stored in a safe, secure area (See included Guidelines for Movable Soccer Goal Safety.). Assembled goal posts should not be left unattended. Remove nets when goals are not in use. Do not use this equipment during the threat of high winds. Goal posts should be checked for safety before and after each use. All warning and safety labels included with this product must be visible at all times. Any modifications to this or any Kwik Goal product will void any and all warranties.

31. To attach the net to the goal, place the base of each net clip over the perimeter rope of the net and into the channel, turning 90 degrees to lock it into place. Start with the top post corners, denoted by a yellow net tag. Use a step ladder if needed to reach the crossbar.

CAUTION: DO NOT ATTEMPT TO CLIMB ON GOAL WHILE ATTACHING NET.
CAUTION: GOALS MUST BE PROPERLY ANCHORED OR STORED AT ALL TIMES.

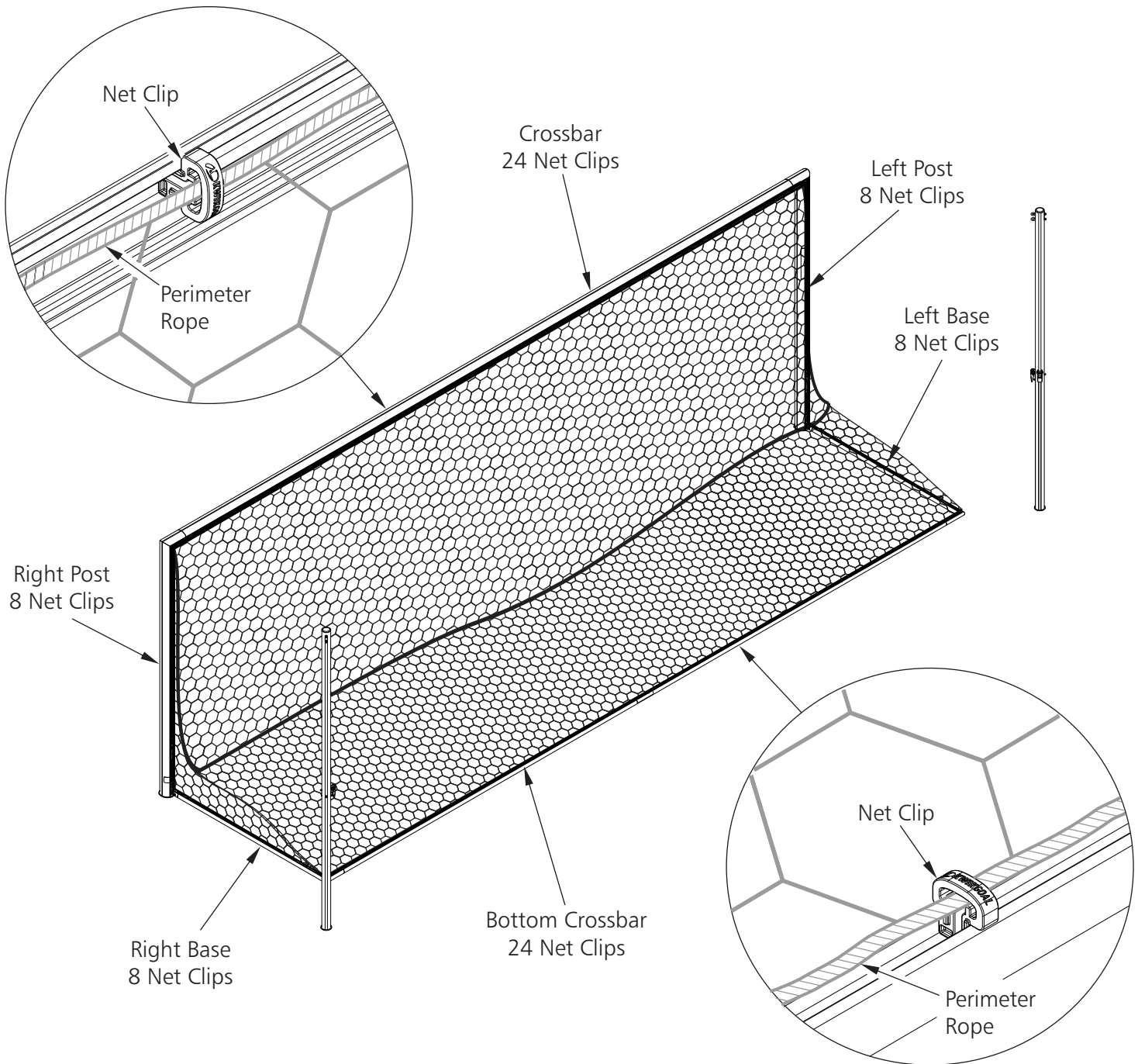

*****CAUTION*****

This goal has been designed to be used for the game of soccer only. Goal posts must be anchored AT ALL TIMES and shall be secured against overturning. Do not climb on the net or goal framework at any time! All fastenings must be checked to insure they are fully tightened before and after each use of this product. Goal posts not in use must be disassembled and properly stored in a safe, secure area (See included Guidelines for Movable Soccer Goal Safety.). Assembled goal posts should not be left unattended. Remove nets when goals are not in use. Do not use this equipment during the threat of high winds. Goal posts should be checked for safety before and after each use.

All warning and safety labels included with this product must be visible at all times.

Any modifications to this or any Kwik Goal product will void any and all warranties.

32. Install the 1st net rope (286" long) onto the goal by weaving it around the top, rear perimeter rope of the net. Take the back pole net straps corresponding to the net tension winches on the front of the back poles and connect the snap link to the perimeter rope at the corner of the net and the 286" net rope.

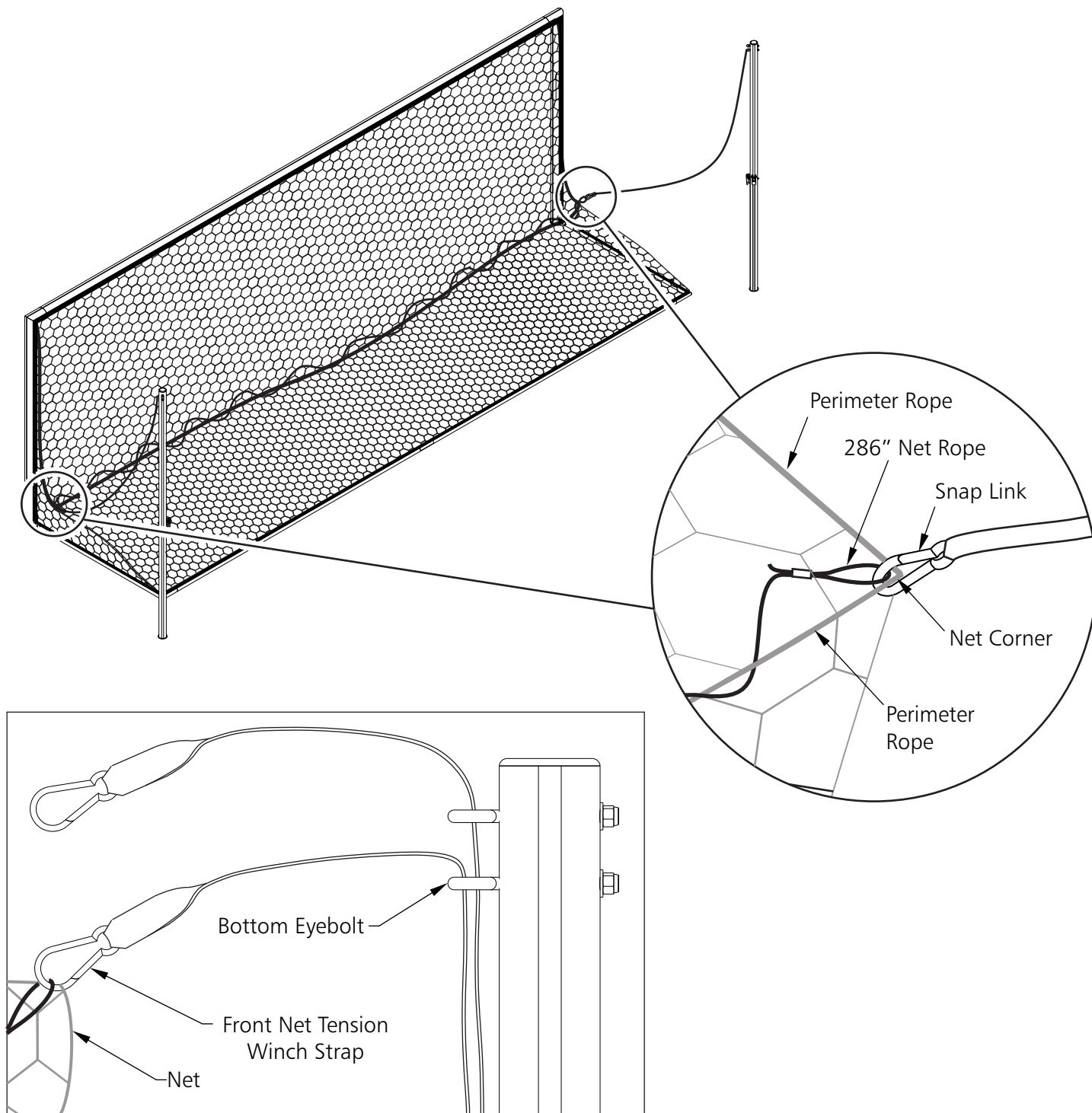

CAUTION

This goal has been designed to be used for the game of soccer only. Goal posts must be anchored AT ALL TIMES and shall be secured against overturning. Do not climb on the net or goal framework at any time! All fastenings must be checked to insure they are fully tightened before and after each use of this product. Goal posts not in use must be disassembled and properly stored in a safe, secure area (See included Guidelines for Movable Soccer Goal Safety.). Assembled goal posts should not be left unattended. Remove nets when goals are not in use. Do not use this equipment during the threat of high winds. Goal posts should be checked for safety before and after each use.

All warning and safety labels included with this product must be visible at all times.

Any modifications to this or any Kwik Goal product will void any and all warranties.

33. Install the 2nd net rope (286" long) onto the goal by weaving it around the top, rear perimeter rope of the net & net rope installed in the previous step, starting 17 meshes in from either side of the goal. Partially raising the net using the net tension winches and straps connected in the previous step may provide easier access. Take the back pole net straps corresponding to the net tension winches on the sides of the back poles and connect the snap link to the 286" net rope only.

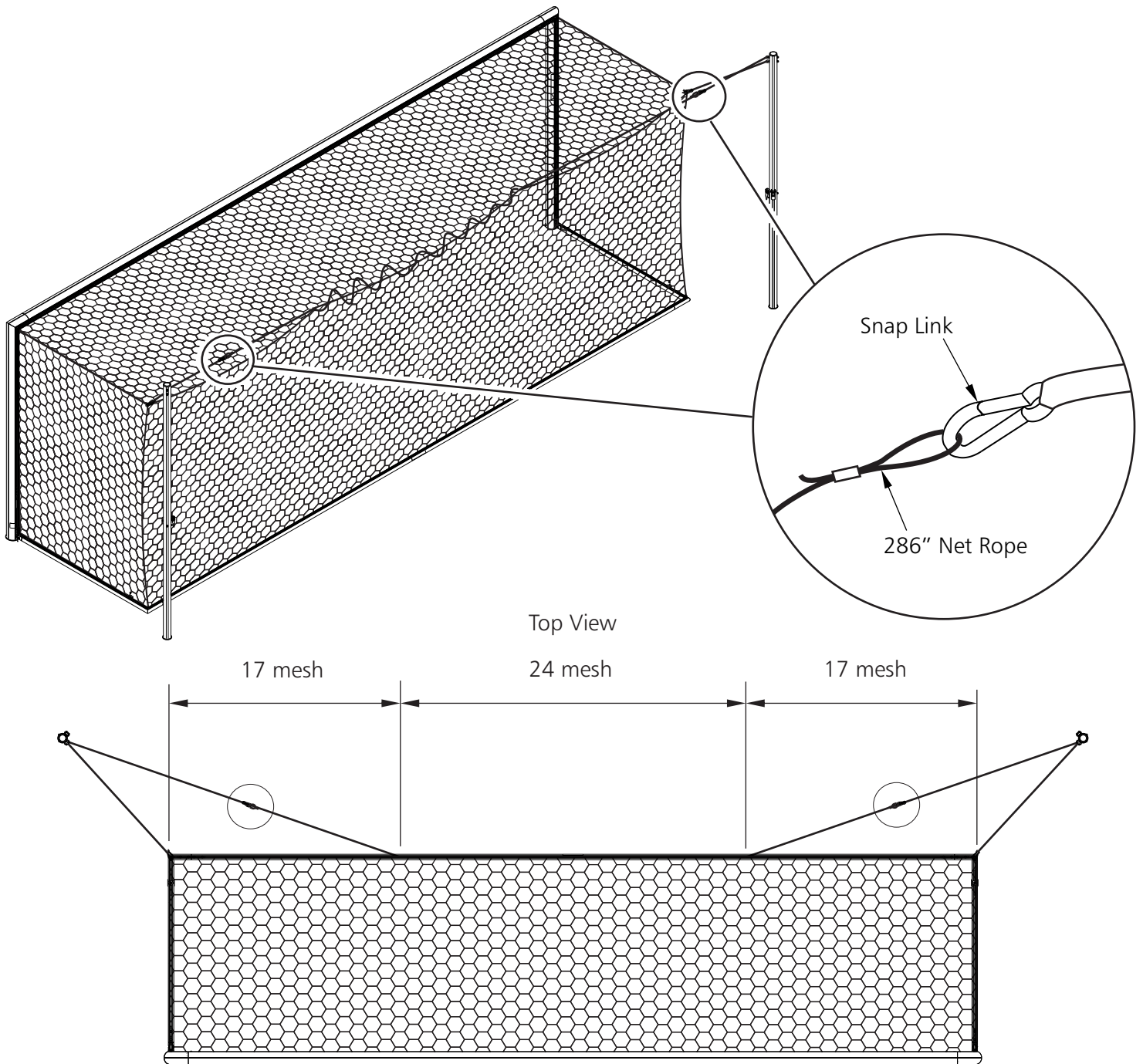

CAUTION

This goal has been designed to be used for the game of soccer only. Goal posts must be anchored AT ALL TIMES and shall be secured against overturning. Do not climb on the net or goal framework at any time! All fastenings must be checked to insure they are fully tightened before and after each use of this product. Goal posts not in use must be disassembled and properly stored in a safe, secure area (See included Guidelines for Movable Soccer Goal Safety.). Assembled goal posts should not be left unattended. Remove nets when goals are not in use. Do not use this equipment during the threat of high winds. Goal posts should be checked for safety before and after each use. All warning and safety labels included with this product must be visible at all times. Any modifications to this or any Kwik Goal product will void any and all warranties.

34. Install the back corner net ropes (97" long) onto the goal by looping one end to the tie down ring on each base, and securing the other end using the snap links already attached to the corners of the net. Do not weave these ropes through the mesh, run them through the interior of the net for their entire length instead.

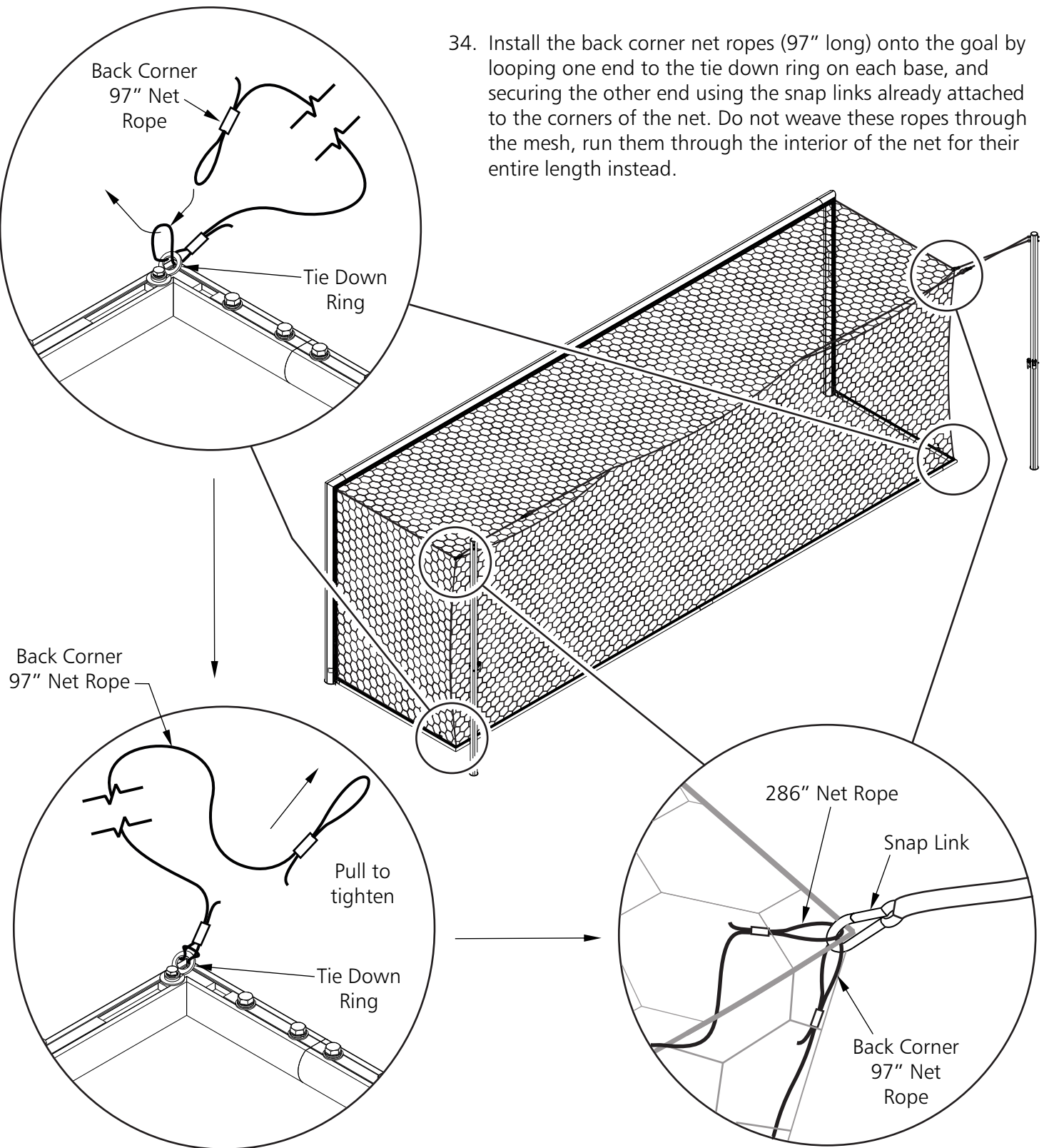

CAUTION

This goal has been designed to be used for the game of soccer only. Goal posts must be anchored AT ALL TIMES and shall be secured against overturning. Do not climb on the net or goal framework at any time! All fastenings must be checked to insure they are fully tightened before and after each use of this product. Goal posts not in use must be disassembled and properly stored in a safe, secure area (See included Guidelines for Movable Soccer Goal Safety.). Assembled goal posts should not be left unattended. Remove nets when goals are not in use. Do not use this equipment during the threat of high winds. Goal posts should be checked for safety before and after each use. All warning and safety labels included with this product must be visible at all times. Any modifications to this or any Kwik Goal product will void any and all warranties.

35. Use the cable ties included with the ground frame hinges to secure each bottom post corner of the net perimeter rope to the cable tie hole on the ground frame hinges as shown below. Once secure, cut off the excess cable tie using scissors.

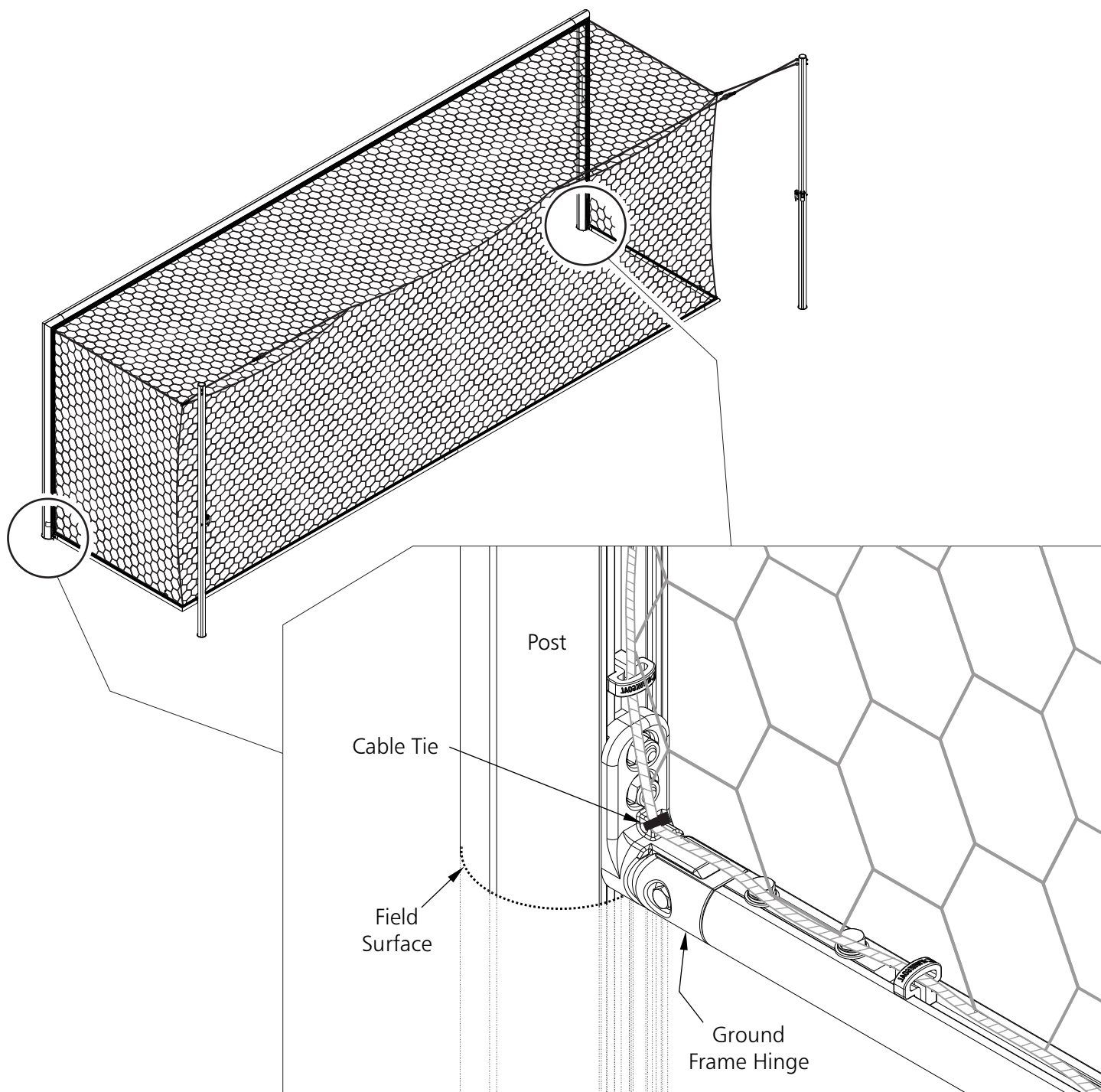

CAUTION

This goal has been designed to be used for the game of soccer only. Goal posts must be anchored AT ALL TIMES and shall be secured against overturning. Do not climb on the net or goal framework at any time! All fastenings must be checked to insure they are fully tightened before and after each use of this product. Goal posts not in use must be disassembled and properly stored in a safe, secure area (See included Guidelines for Movable Soccer Goal Safety.). Assembled goal posts should not be left unattended. Remove nets when goals are not in use. Do not use this equipment during the threat of high winds. Goal posts should be checked for safety before and after each use. All warning and safety labels included with this product must be visible at all times. Any modifications to this or any Kwik Goal product will void any and all warranties.

36. Secure the top corners of the net perimeter rope to the goal frame by passing the included heavy duty cable ties through the previously installed tie down rings. Reducing tension on the net by loosening the net tension winches may help manipulate the mesh more easily. Once secure, cut off the excess cable tie using scissors.

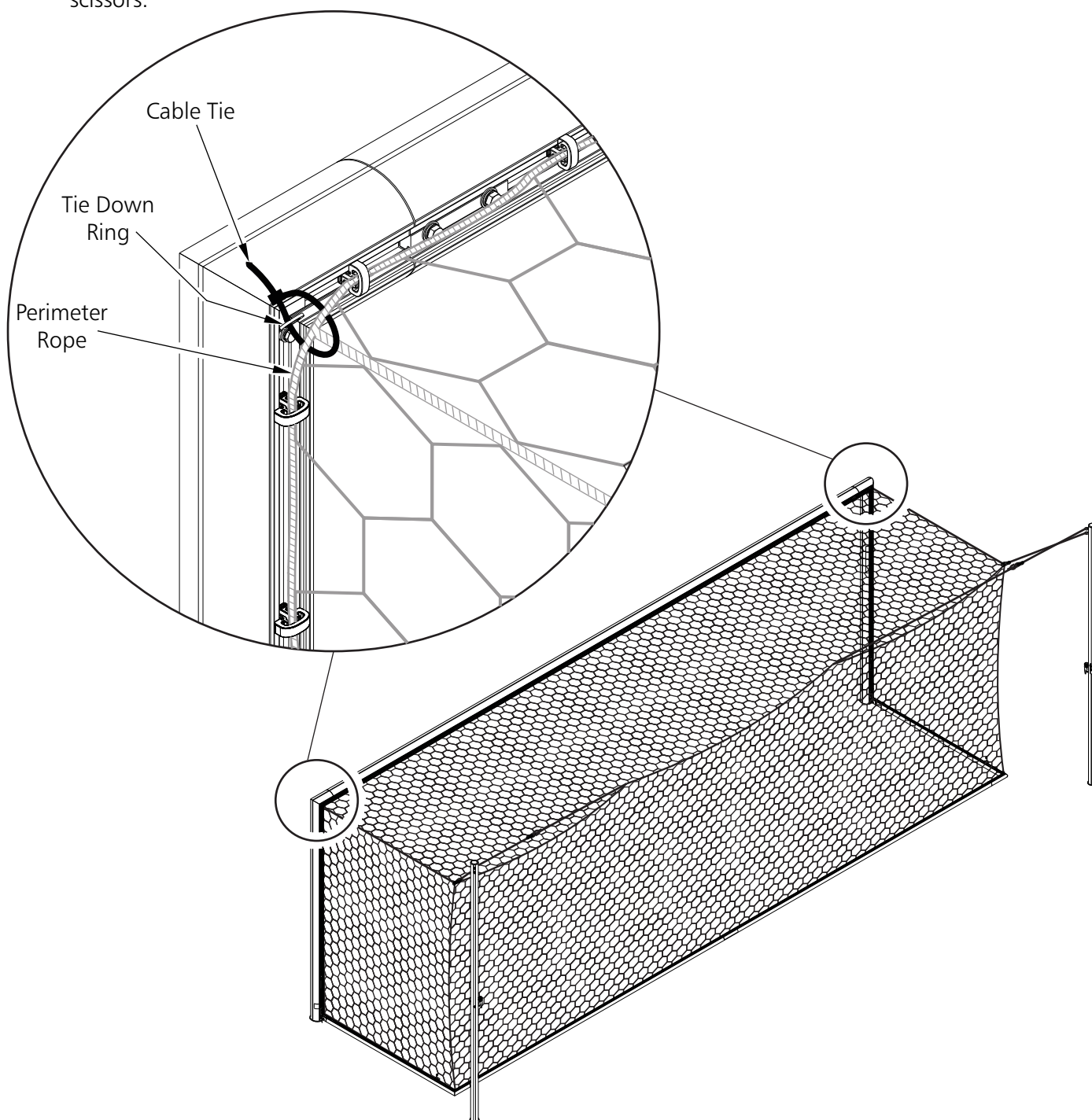

CAUTION

This goal has been designed to be used for the game of soccer only. Goal posts must be anchored AT ALL TIMES and shall be secured against overturning. Do not climb on the net or goal framework at any time! All fastenings must be checked to insure they are fully tightened before and after each use of this product. Goal posts not in use must be disassembled and properly stored in a safe, secure area (See included Guidelines for Movable Soccer Goal Safety.). Assembled goal posts should not be left unattended. Remove nets when goals are not in use. Do not use this equipment during the threat of high winds. Goal posts should be checked for safety before and after each use.

All warning and safety labels included with this product must be visible at all times.
Any modifications to this or any Kwik Goal product will void any and all warranties.

37. Prepare to attach the back pole pads to the goal. Identify the left and right pad by checking the part number located on the inside of the access hatch. The pads will only fit if the correct side is facing upwards; hold the pad in place and visually verify that the net tension winches align correctly with the access hatch.
38. Attach the back pole pads to the goal. Undo the hook & loop flap and begin fitting the pad to the pole starting at the top and working your way down. Be sure to keep the access hatch aligned with the net tension winches, as it will be difficult to rotate once the entire pad is installed.

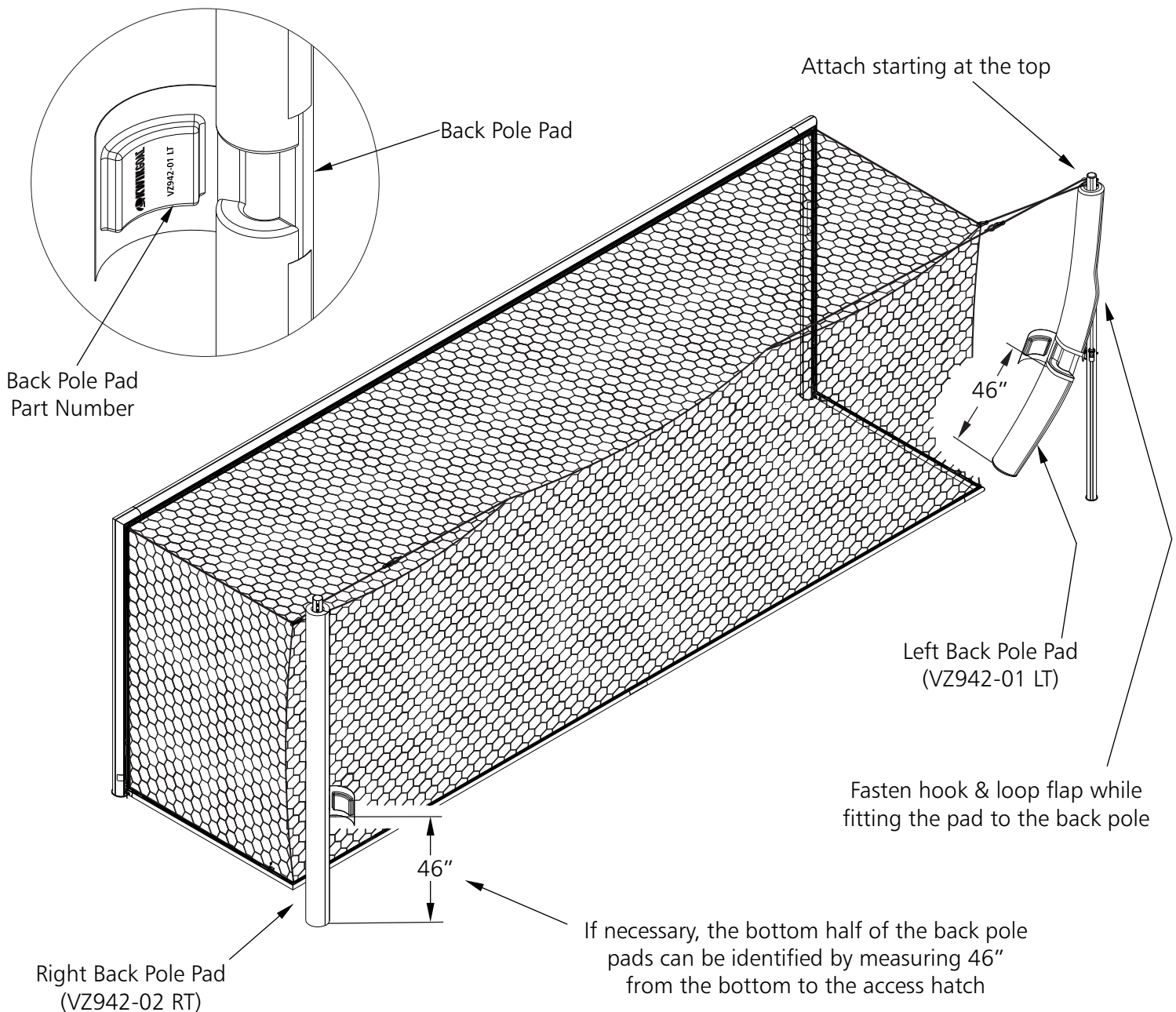

CAUTION

This goal has been designed to be used for the game of soccer only. Goal posts must be anchored AT ALL TIMES and shall be secured against overturning. Do not climb on the net or goal framework at any time! All fastenings must be checked to insure they are fully tightened before and after each use of this product. Goal posts not in use must be disassembled and properly stored in a safe, secure area (See included Guidelines for Movable Soccer Goal Safety.). Assembled goal posts should not be left unattended. Remove nets when goals are not in use. Do not use this equipment during the threat of high winds. Goal posts should be checked for safety before and after each use. All warning and safety labels included with this product must be visible at all times. Any modifications to this or any Kwik Goal product will void any and all warranties.

39. To adjust the tilt of the goal, refer to step 11.

40. To adjust the height of the goal frame, use the supplied socket driver with an 8mm socket to turn the height adjustment screw located on each post. For best results, start from a lower position and raise the crossbar up to the correct height. Always verify that the crossbar is level and exactly 8'0" [2438 mm] above the field surface.

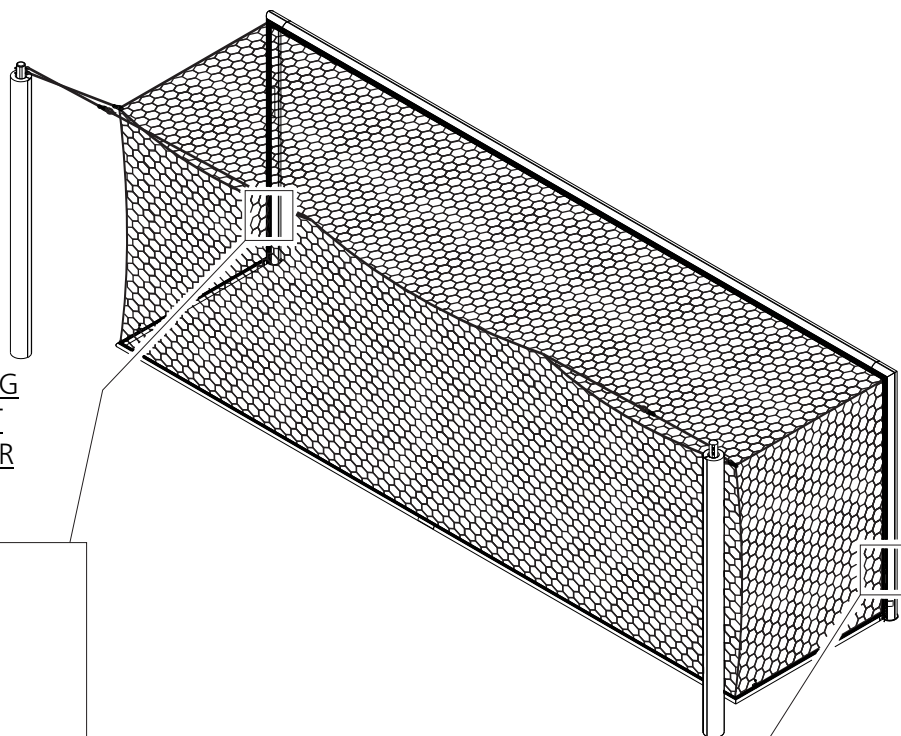

NOTE: ONLY MAKE GOAL ADJUSTMENTS USING THE INCLUDED SOCKET DRIVER, DO NOT USE POWER TOOLS, RATCHETS, OR OTHER HIGH-LEVERAGE TOOLS

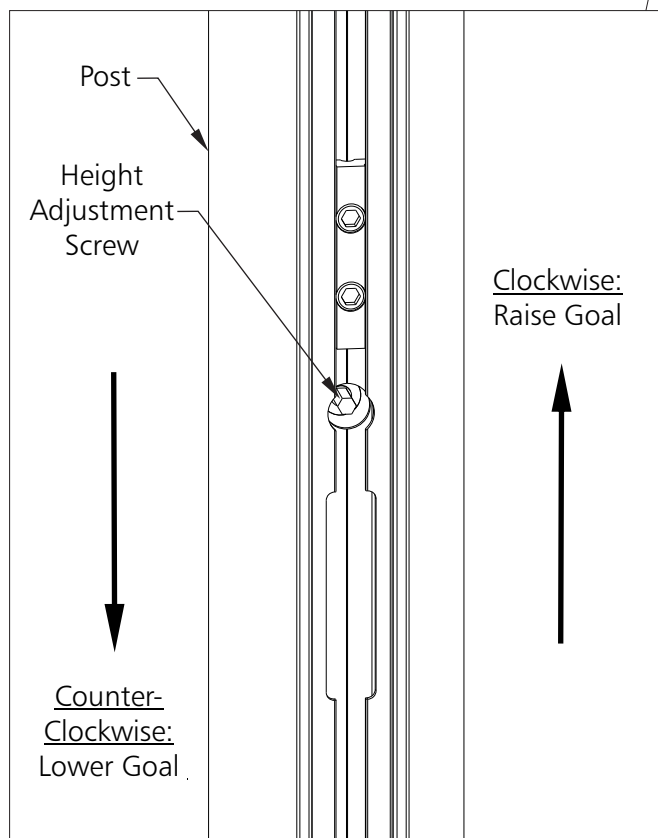

NOTE: THIS QR CODE LINKING TO OPERATION INSTRUCTIONS CAN ALSO BE FOUND ON EACH GOAL POST



OPERATION INSTRUCTIONS

CAUTION

This goal has been designed to be used for the game of soccer only. Goal posts must be anchored AT ALL TIMES and shall be secured against overturning. Do not climb on the net or goal framework at any time! All fastenings must be checked to insure they are fully tightened before and after each use of this product. Goal posts not in use must be disassembled and properly stored in a safe, secure area (See included Guidelines for Movable Soccer Goal Safety.). Assembled goal posts should not be left unattended. Remove nets when goals are not in use. Do not use this equipment during the threat of high winds. Goal posts should be checked for safety before and after each use. All warning and safety labels included with this product must be visible at all times. Any modifications to this or any Kwik Goal product will void any and all warranties.

41. To lift the ground frame up off of the field surface for maintenance refer to steps 42a and 42b below.
To remove the goal from the ground for storage refer to steps 43a and 43b on the next page.

42a. To lift ground frame up off of the field surface for maintenance, remove the ground frame anchor bolt by loosening the ground frame knob and lift the ground frame as shown below. Remove and store the ground frame hold down hardware and ground frame spacer when the frame is in the lifted position.

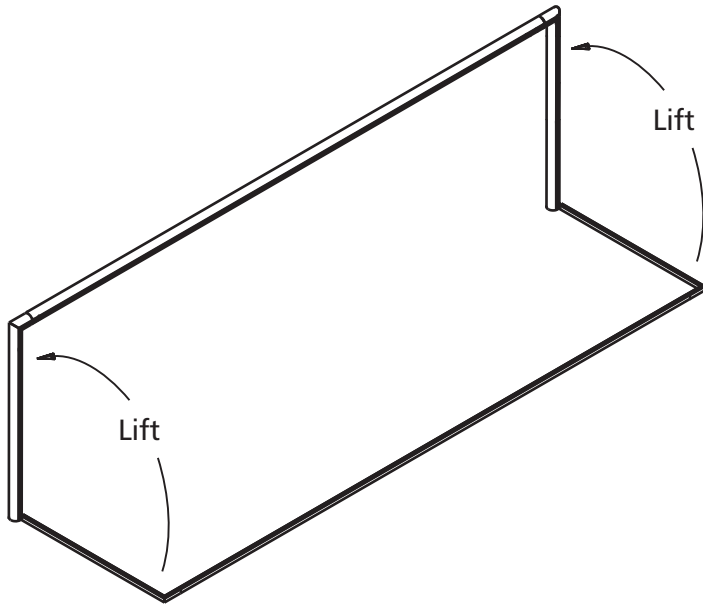

NOTE: ATTACH NET TO POST OF GOAL WITH NET FASTENER. BE SURE TO CUT PIECES TO A LENGTH OF 20" WHICH WILL ALLOW A 2" OVERLAP.

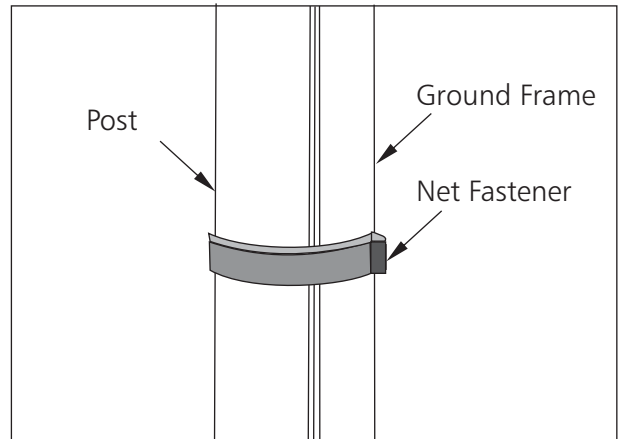

42b. Grease and install the 3/8" flat tip set screws into the ground frame anchors and cover using the ground frame anchor caps to prevent debris from entering the anchors.

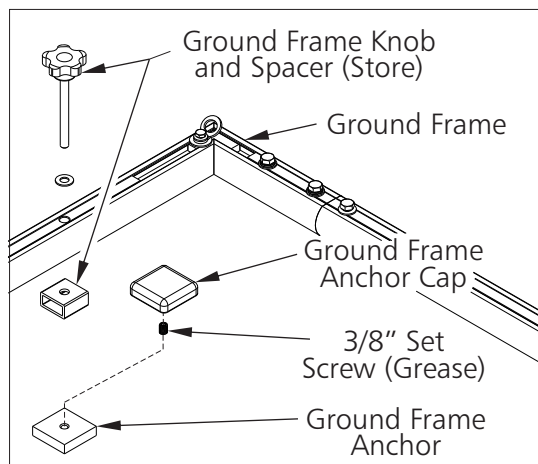

*****CAUTION*****

This goal has been designed to be used for the game of soccer only. Goal posts must be anchored AT ALL TIMES and shall be secured against overturning. Do not climb on the net or goal framework at any time! All fastenings must be checked to insure they are fully tightened before and after each use of this product. Goal posts not in use must be disassembled and properly stored in a safe, secure area (See included Guidelines for Movable Soccer Goal Safety.). Assembled goal posts should not be left unattended. Remove nets when goals are not in use. Do not use this equipment during the threat of high winds. Goal posts should be checked for safety before and after each use.

All warning and safety labels included with this product must be visible at all times.

Any modifications to this or any Kwik Goal product will void any and all warranties.

- 43a. To remove the goal from the field for storage, first refer to steps 42a and 42b to secure the ground frame to the goal posts, and install the set screws and caps on the ground frame anchors. Clear away all soil and debris from top of post ground sleeves and back pole ground sleeves and remove the goal and back poles from the ground. Disassemble and store the goal and back poles in a safe place to prevent injury.

See **GUIDELINES FOR MOVEABLE SOCCER GOALS**, included for proper storage procedures.

- 43b. After removing the goal and backpoles from the ground, install the post ground sleeve caps and backpole ground sleeve caps in all ground sleeve openings.

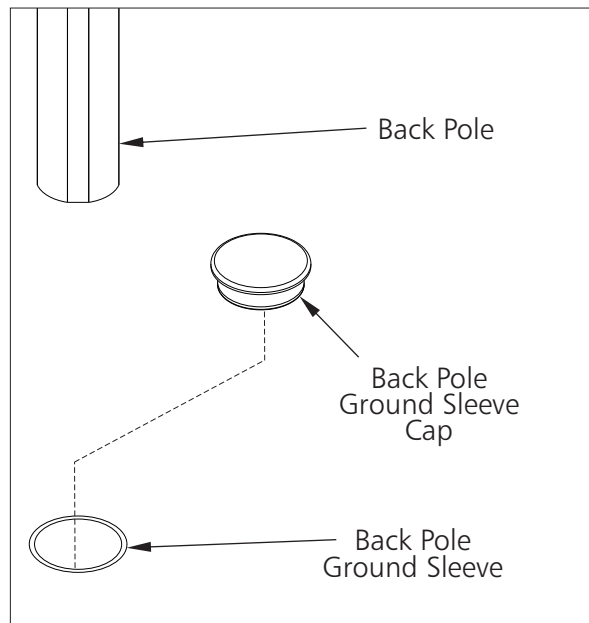
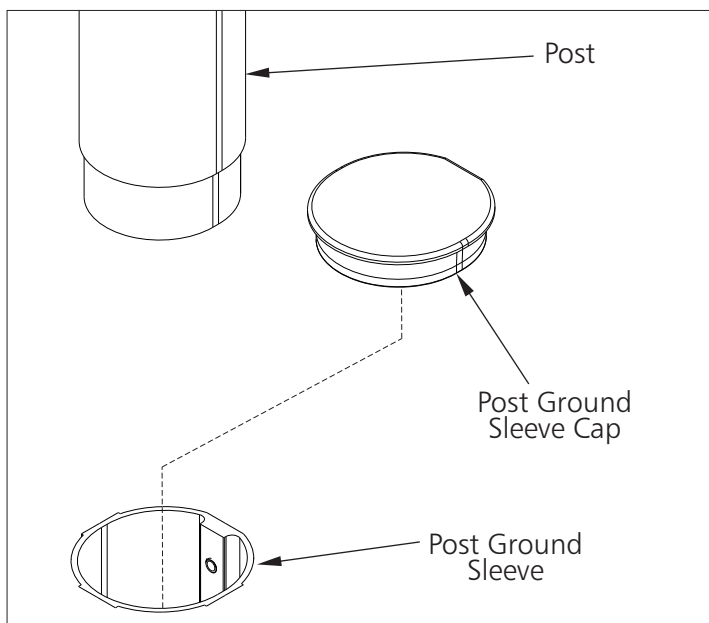

Go to kwikgoal.com for additional product information.

*****CAUTION*****

This goal has been designed to be used for the game of soccer only. Goal posts must be anchored AT ALL TIMES and shall be secured against overturning. Do not climb on the net or goal framework at any time! All fastenings must be checked to insure they are fully tightened before and after each use of this product. Goal posts not in use must be disassembled and properly stored in a safe, secure area (See included Guidelines for Movable Soccer Goal Safety.). Assembled goal posts should not be left unattended. Remove nets when goals are not in use. Do not use this equipment during the threat of high winds. Goal posts should be checked for safety before and after each use.

All warning and safety labels included with this product must be visible at all times.

Any modifications to this or any Kwik Goal product will void any and all warranties.