

# BBSBFP-15 / BBSBFP-12

15' / 12' Baseball / Softball Foul Pole

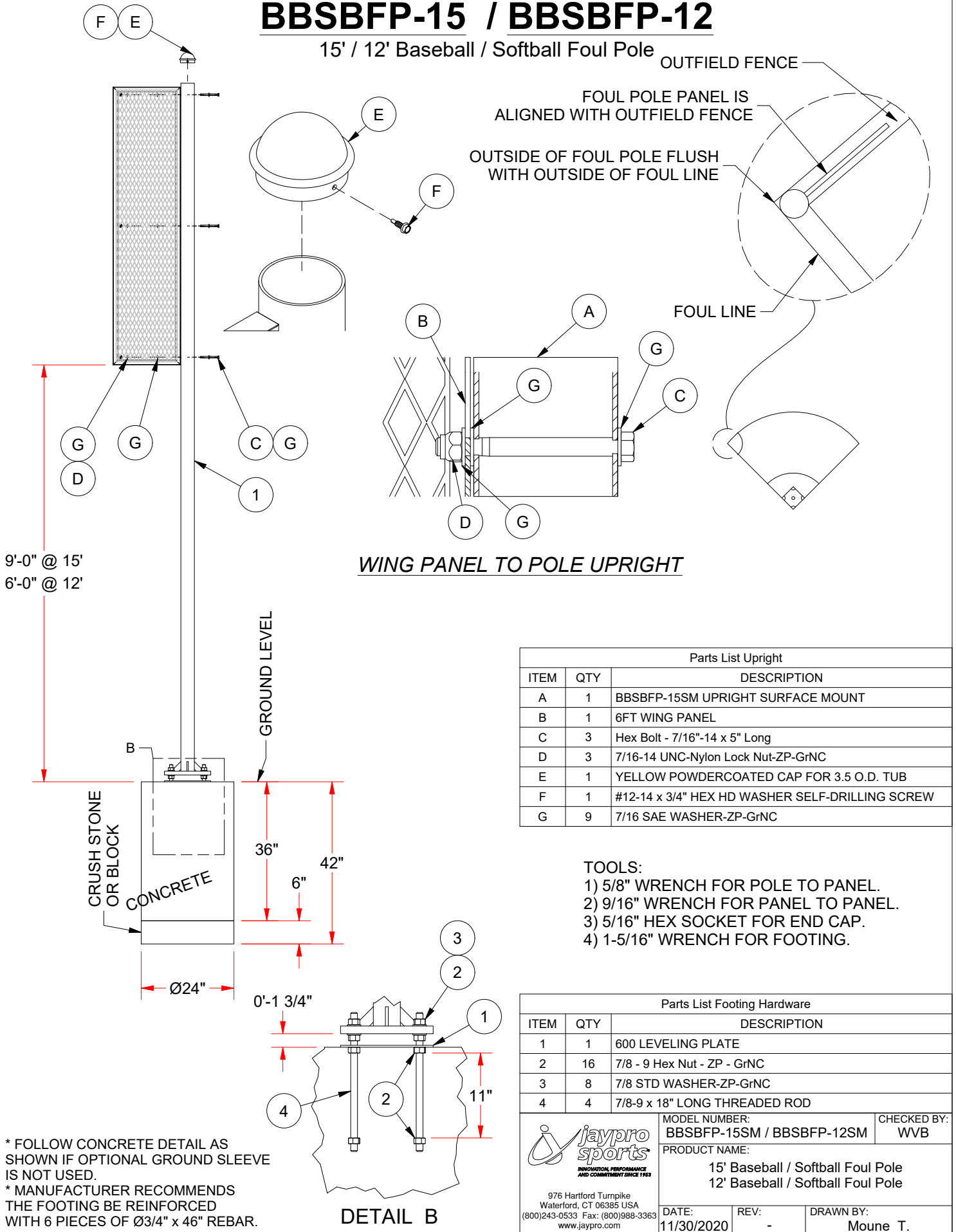

\* FOLLOW CONCRETE DETAIL AS SHOWN IF OPTIONAL GROUND SLEEVE IS NOT USED.  
 \* MANUFACTURER RECOMMENDS THE FOOTING BE REINFORCED WITH 6 PIECES OF Ø3/4" x 46" REBAR.